

LOCATION MAP

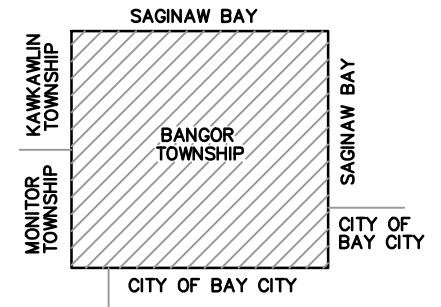

LEGEND

- ADJACENT COUNTY
- CITY, VILLAGE OR PRIVATE STREET
- URBAN LIMITS
- COUNTY PRIMARY ROADS
- COUNTY LOCAL ROADS
- STATE TRUNK LINE
- RAILROADS
- CITY OR VILLAGE LIMITS
- SECTION LINES

PRIMARY ROAD SYSTEM 31.40 MILES  
 LOCAL ROAD SYSTEM 4.66 MILES



SCALE: 1" = 3000'

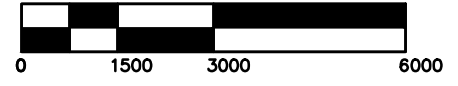

REVISED BY: EJD

DATE: 01/21/2018

BANGOR TOWNSHIP

T.14-15 N. - R.05 E.  
 BAY COUNTY

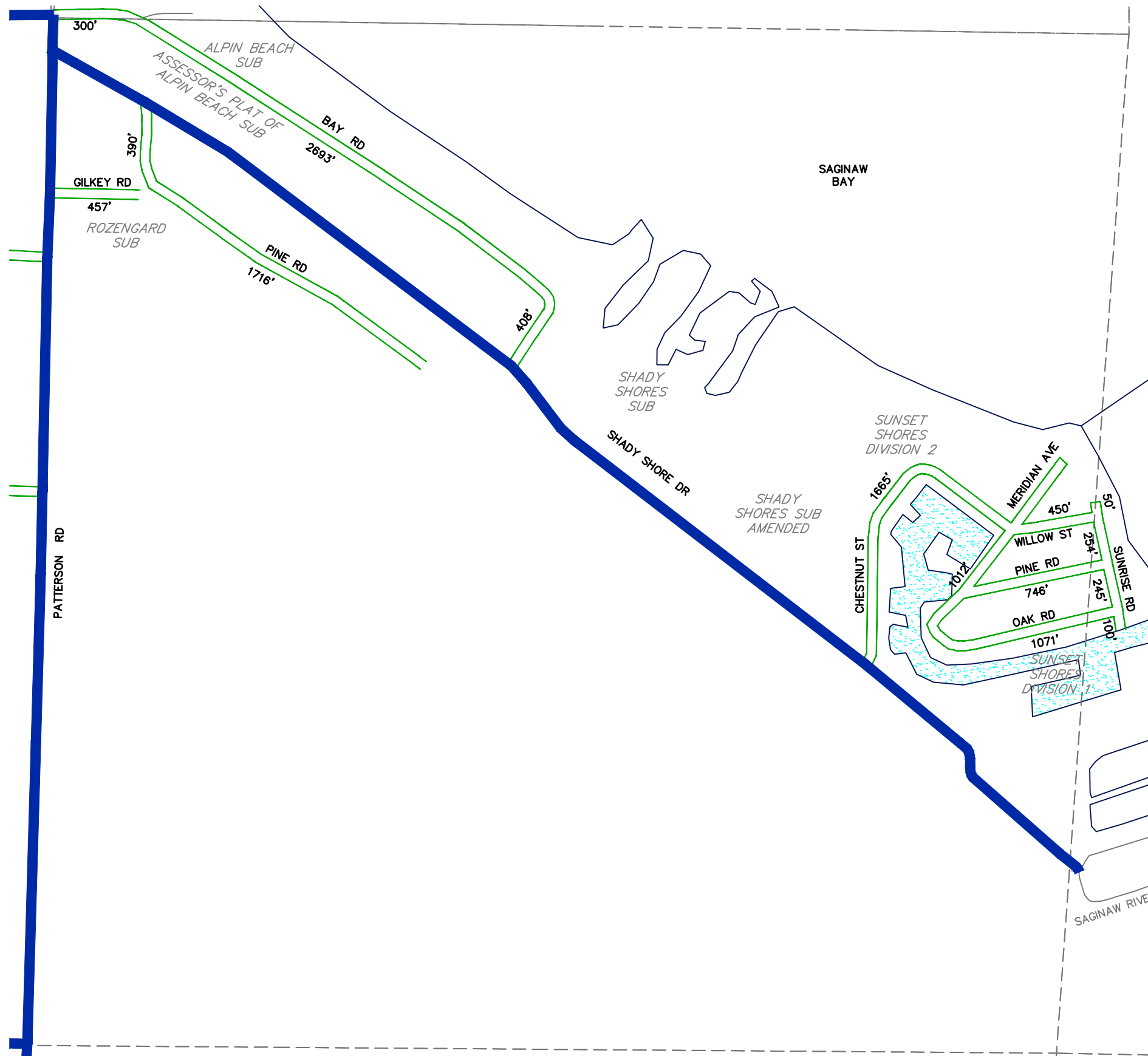

**LEGEND**

- SECTION LINES
- ADJACENT COUNTY
- CITY, VILLAGE OR PRIVATE STREET
- URBAN LIMITS
- COUNTY PRIMARY ROADS
- COUNTY LOCAL ROADS
- STATE TRUNK LINE
- RAILROAD TRACKS
- CITY OR VILLAGE LIMITS

TOTAL FEET 11,557 = 2.19 MILES

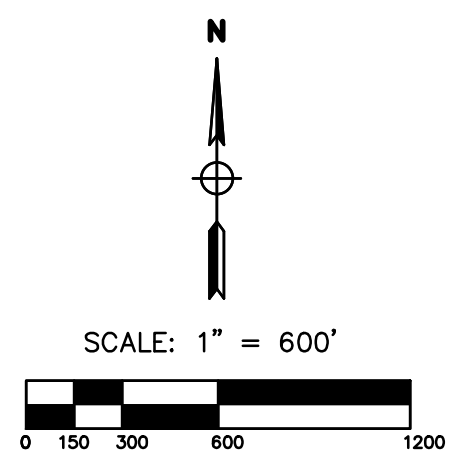





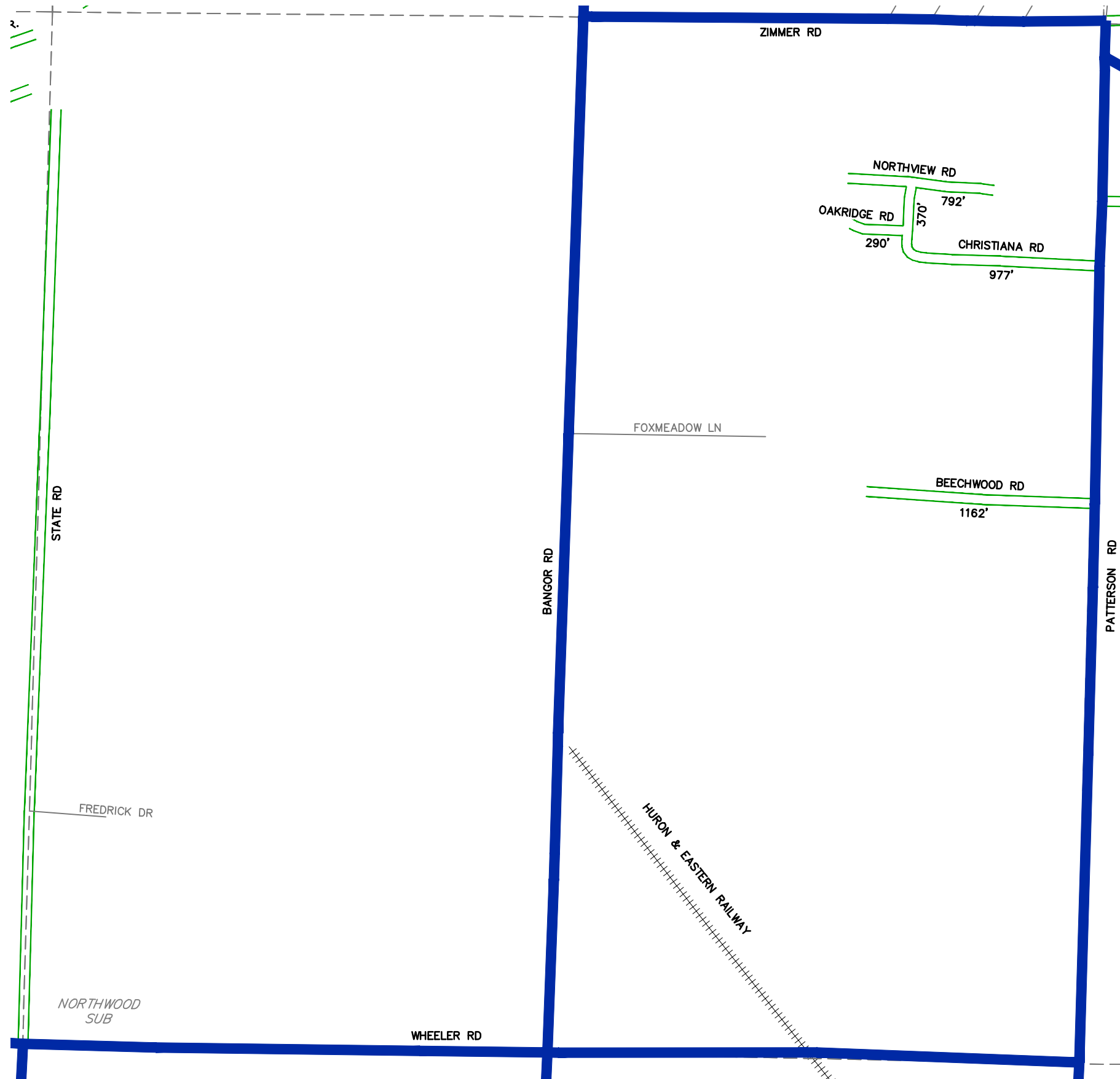

REVISED BY: CLW  
 DATE: 05/05/14

**BANGOR TOWNSHIP**  
 SECTION 3  
 T.14 N. - R.05 E.  
 BAY COUNTY

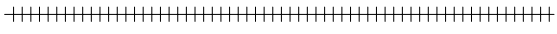

**LEGEND**

- - - - - SECTION LINES
-  - ADJACENT COUNTY
- - - - - CITY, VILLAGE OR PRIVATE STREET
- - - - - URBAN LIMITS
-  - COUNTY PRIMARY ROADS
-  - COUNTY LOCAL ROADS
-  - STATE TRUNK LINE
-  - RAILROAD TRACKS
-  - CITY OR VILLAGE LIMITS

TOTAL FEET 3,591 = 0.68 MILES

N



SCALE: 1" = 600'



REVISED BY: CLW

DATE: 05/05/14

**BANGOR TOWNSHIP**

SECTION 4  
T.14 N. - R.05 E.  
BAY COUNTY

**LEGEND**

- SECTION LINES
- ADJACENT COUNTY
- CITY, VILLAGE OR PRIVATE STREET
- URBAN LIMITS
- COUNTY PRIMARY ROADS
- COUNTY LOCAL ROADS
- STATE TRUNK LINE
- RAILROAD TRACKS
- CITY OR VILLAGE LIMITS

TOTAL FEET 19,112 = 3.62 MILES



SCALE: 1" = 600'



REVISED BY: EJD

DATE: 01/21/2018

**BANGOR TOWNSHIP**  
 SECTION 5  
 T.14 N. - R.05 E.  
 BAY COUNTY

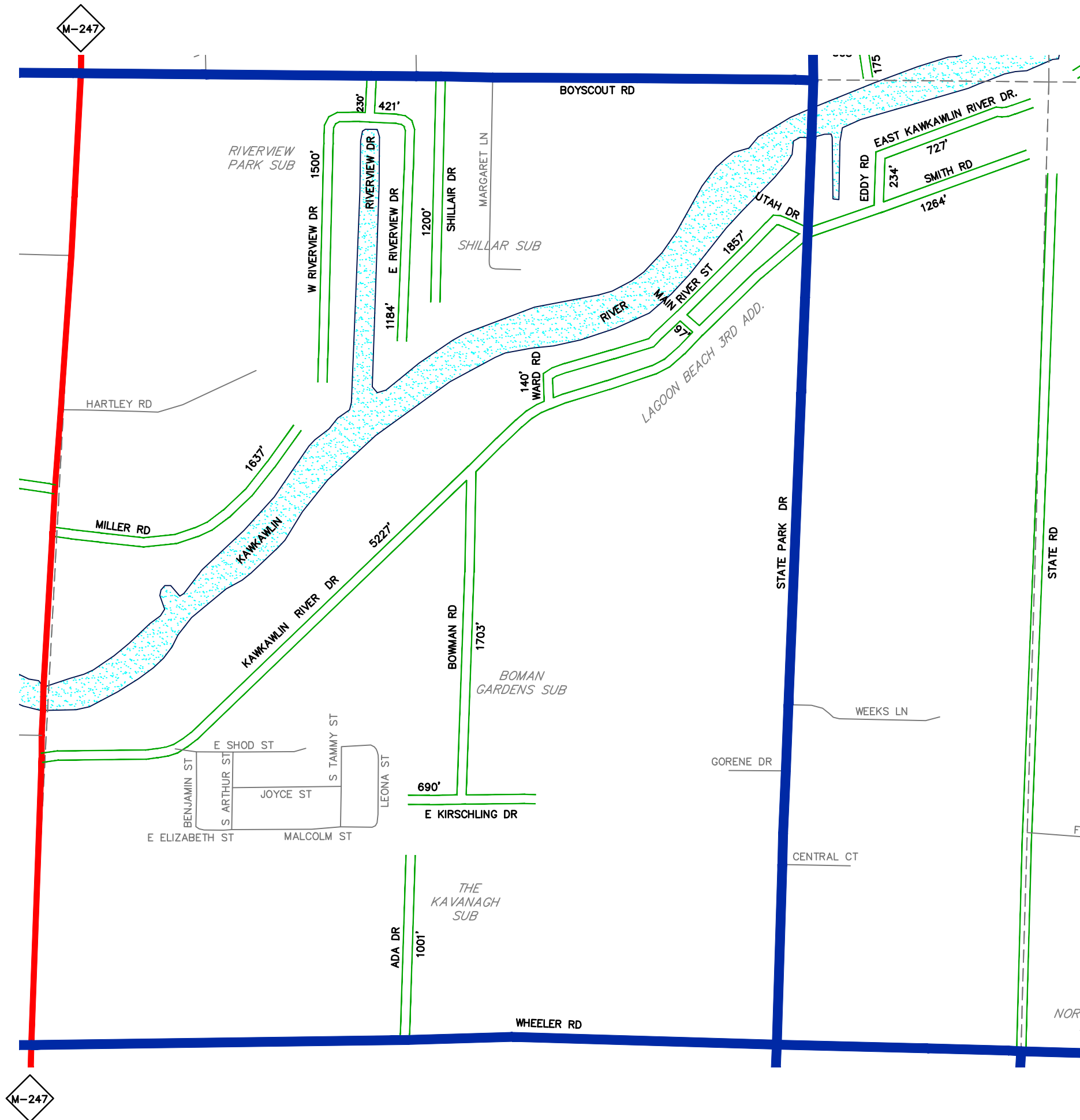

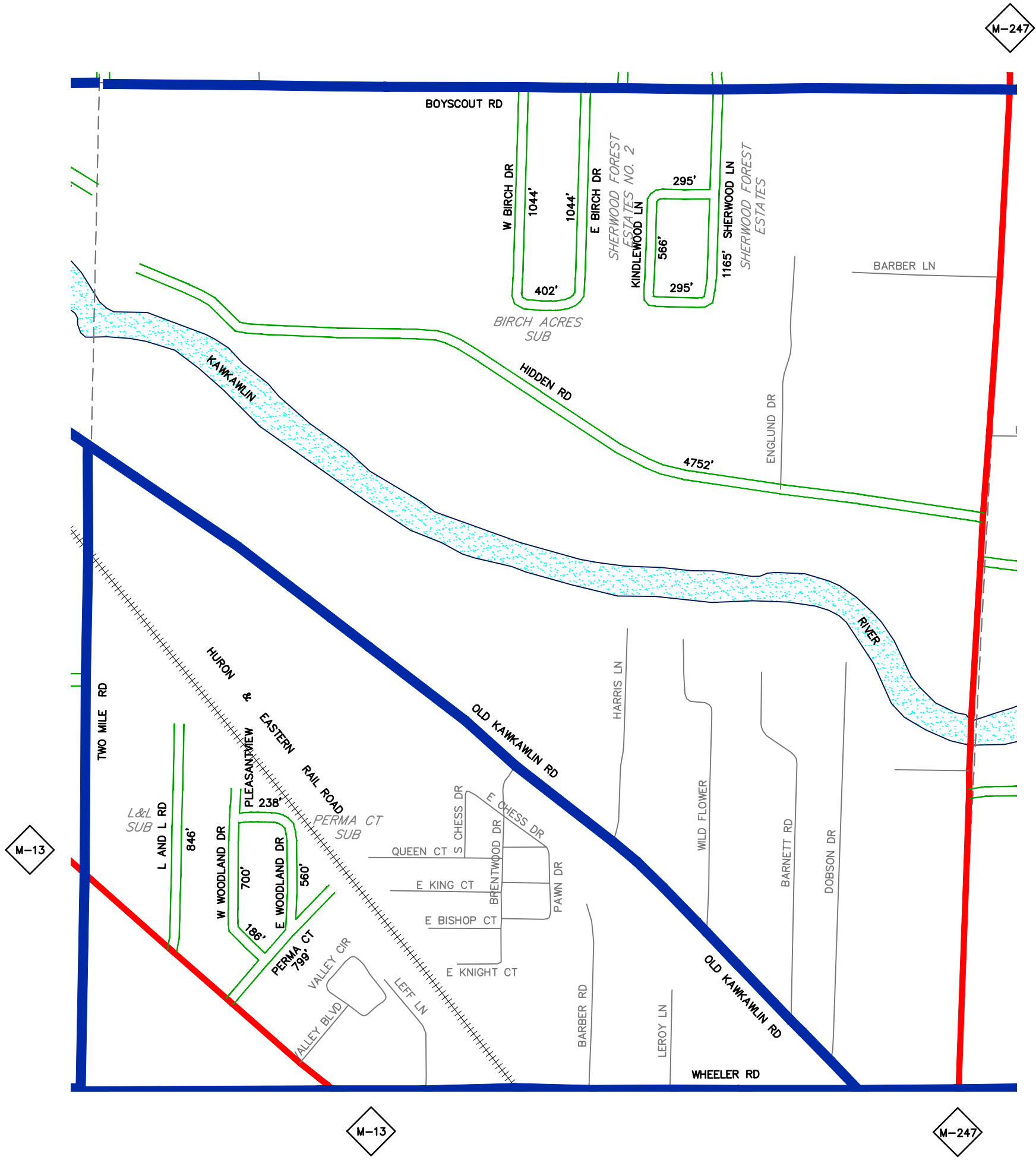

**LEGEND**

- SECTION LINES
- ADJACENT COUNTY
- CITY, VILLAGE OR PRIVATE STREET
- URBAN LIMITS
- COUNTY PRIMARY ROADS
- COUNTY LOCAL ROADS
- STATE TRUNK LINE
- RAILROAD TRACKS
- CITY OR VILLAGE LIMITS

TOTAL FEET 12,892 = 2.44 MILES

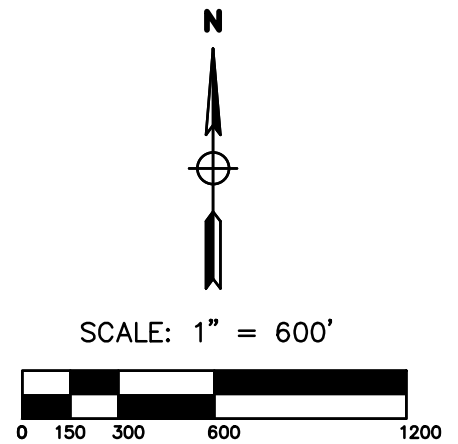

REVISED BY: CLW  
 DATE: 05/05/14

**BANGOR TOWNSHIP**  
 SECTION 6  
 T.14 N. - R.05 E.  
 BAY COUNTY

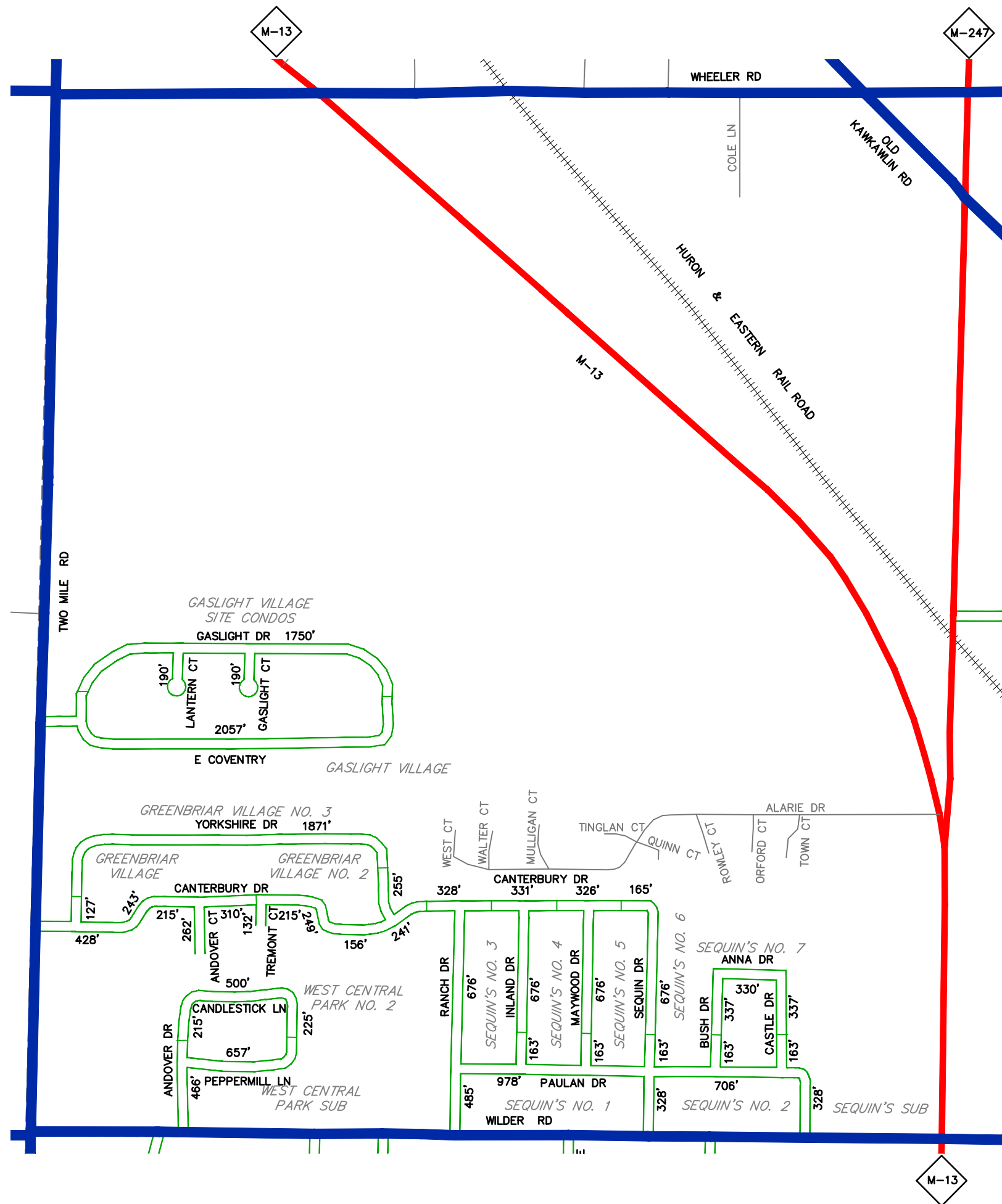

**LEGEND**

- SECTION LINES
- ADJACENT COUNTY
- CITY, VILLAGE OR PRIVATE STREET
- URBAN LIMITS
- COUNTY PRIMARY ROADS
- COUNTY LOCAL ROADS
- STATE TRUNK LINE
- RAILROAD TRACKS
- CITY OR VILLAGE LIMITS

TOTAL FEET 20,126 = 3.81 MILES



SCALE: 1" = 600'

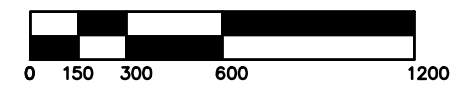

REVISED BY: CLW

DATE: 05/05/14

**BANGOR TOWNSHIP**

SECTION 7  
T.14 N. - R.05 E.  
BAY COUNTY

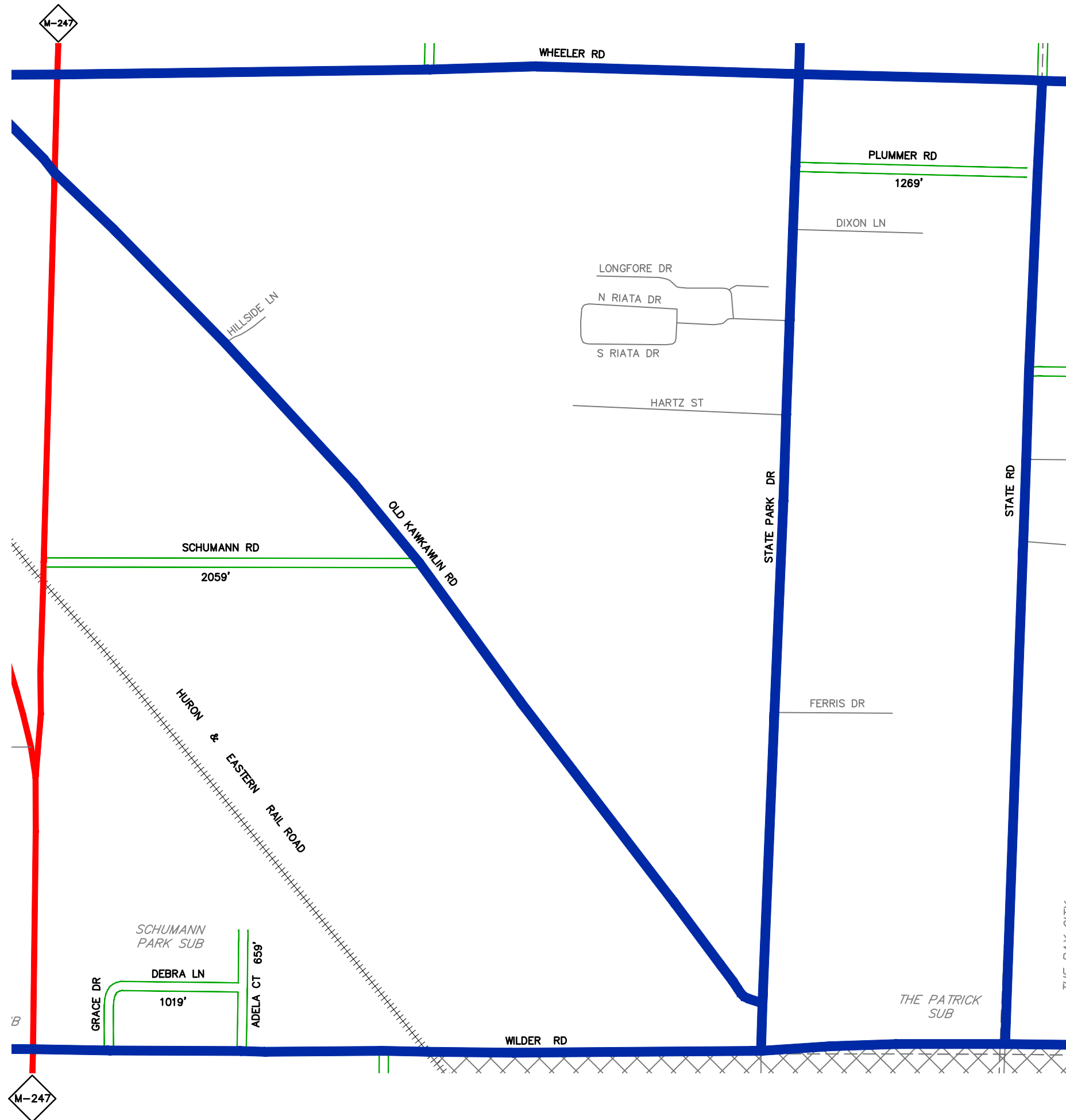

**LEGEND**

- SECTION LINES
- ADJACENT COUNTY
- CITY, VILLAGE OR PRIVATE STREET
- URBAN LIMITS
- COUNTY PRIMARY ROADS
- COUNTY LOCAL ROADS
- STATE TRUNK LINE
- RAILROAD TRACKS
- CITY OR VILLAGE LIMITS

TOTAL FEET 5,006 = 0.95 MILES



SCALE: 1" = 600'

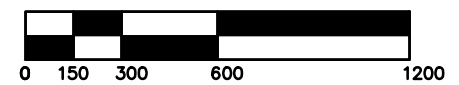

REVISED BY: CLW

DATE: 05/05/14

**BANGOR TOWNSHIP**

SECTION 8  
T.14 N. - R.05 E.  
BAY COUNTY

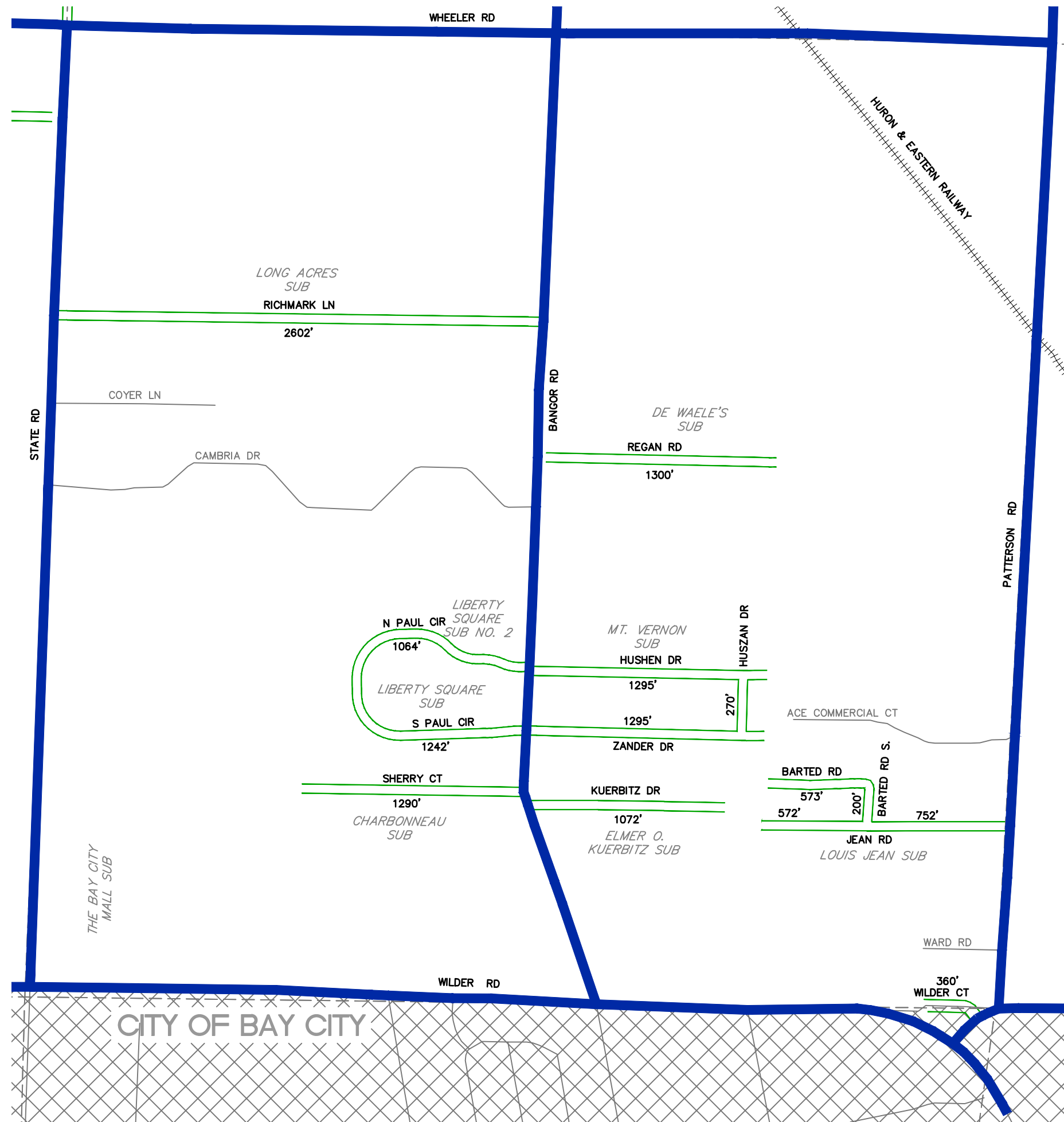

**LEGEND**

- - - - - SECTION LINES
- ==== ADJACENT COUNTY
- \_\_\_\_\_ CITY, VILLAGE OR PRIVATE STREET
- \_\_\_\_\_ URBAN LIMITS
- ==== COUNTY PRIMARY ROADS
- ==== COUNTY LOCAL ROADS
- ==== STATE TRUNK LINE
- +++++ RAILROAD TRACKS
- XXXXX CITY OR VILLAGE LIMITS

TOTAL FEET 13,887 = 2.63 MILES



SCALE: 1" = 600'



REVISED BY: CLW

DATE: 02/13/15

**BANGOR TOWNSHIP**

SECTION 9  
T.14 N. - R.05 E.  
BAY COUNTY



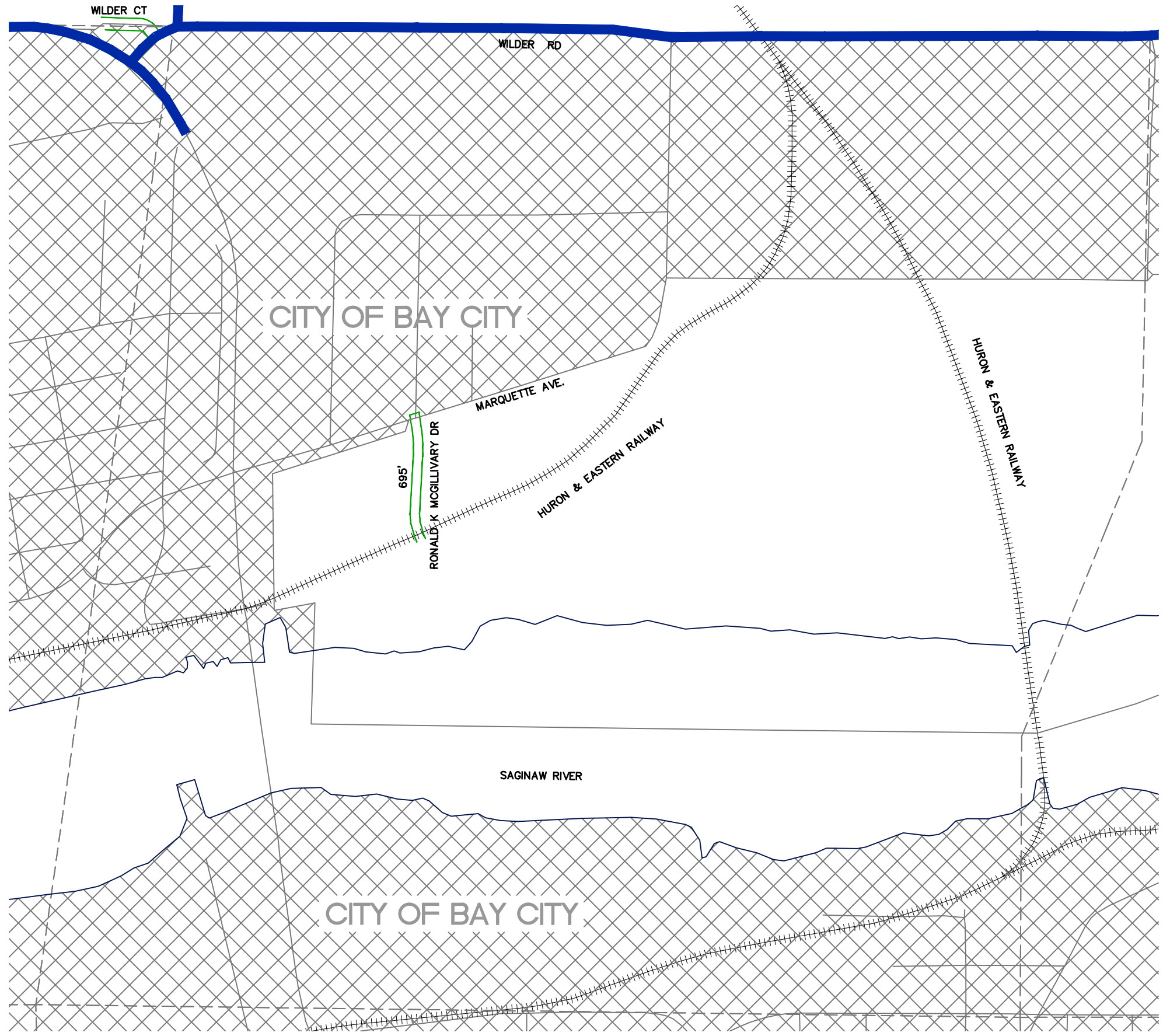

**LEGEND**

- SECTION LINES
- ADJACENT COUNTY
- CITY, VILLAGE OR PRIVATE STREET
- URBAN LIMITS
- COUNTY PRIMARY ROADS
- COUNTY LOCAL ROADS
- STATE TRUNK LINE
- RAILROAD TRACKS
- CITY OR VILLAGE LIMITS

TOTAL FEET 695 = 0.13 MILES



SCALE: 1" = 600'



REVISED BY: CLW

DATE: 05/05/14

**BANGOR TOWNSHIP**

SECTION 15  
T.14 N. - R.05 E.  
BAY COUNTY

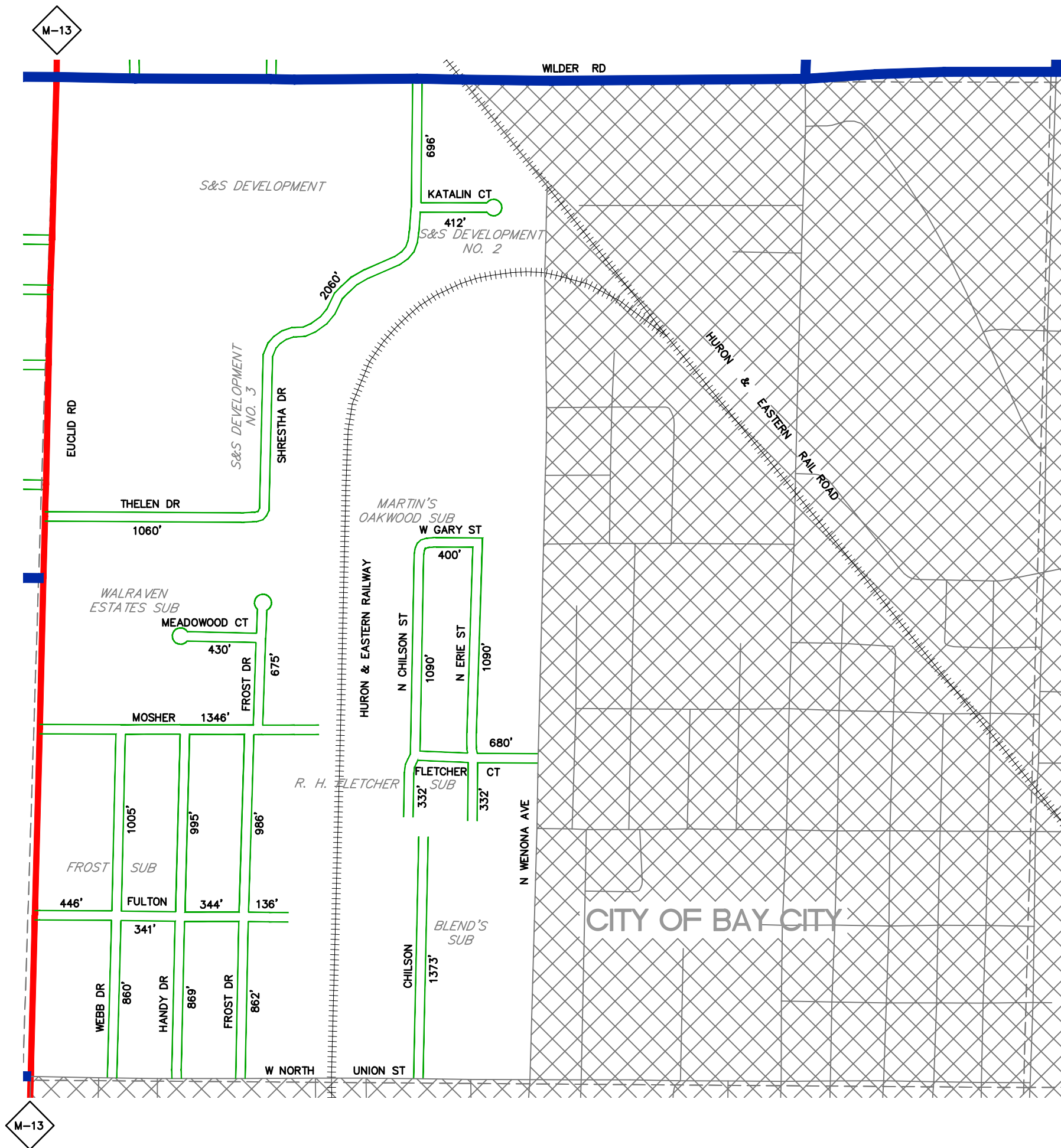

**LEGEND**

- SECTION LINES
- ADJACENT COUNTY
- CITY, VILLAGE OR PRIVATE STREET
- URBAN LIMITS
- COUNTY PRIMARY ROADS
- COUNTY LOCAL ROADS
- STATE TRUNK LINE
- RAILROAD TRACKS
- CITY OR VILLAGE LIMITS

TOTAL FEET 18,820 = 3.56 MILES



SCALE: 1" = 600'



REVISED BY: CLW

DATE: 05/05/14

**BANGOR TOWNSHIP**

SECTION 17  
T.14 N. - R.05 E.  
BAY COUNTY

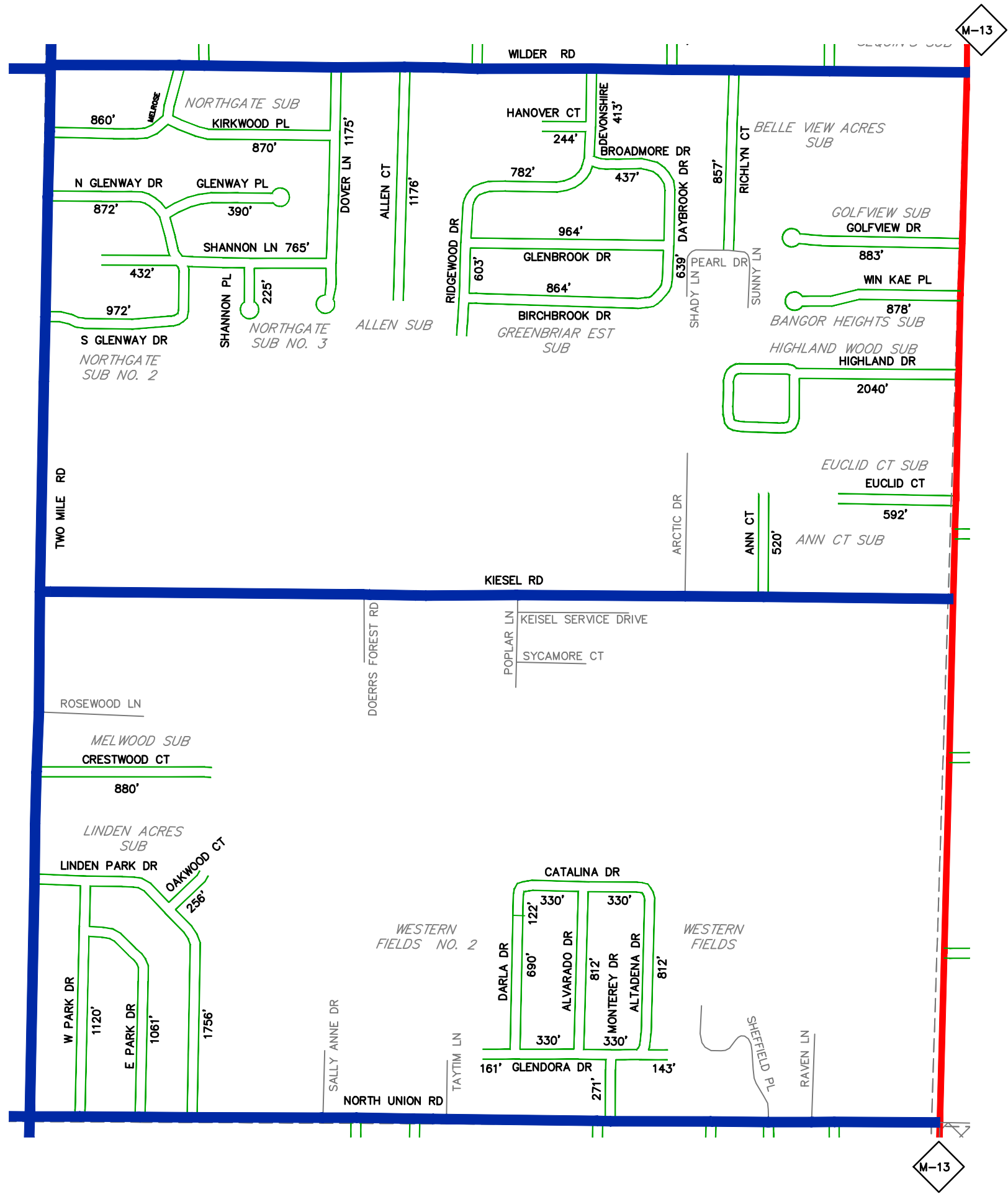

**LEGEND**

- - - - - SECTION LINES
- ==== ADJACENT COUNTY
- \_\_\_\_\_ CITY, VILLAGE OR PRIVATE STREET
- \_\_\_\_\_ URBAN LIMITS
- ==== COUNTY PRIMARY ROADS
- ==== COUNTY LOCAL ROADS
- ==== STATE TRUNK LINE
- +++++ RAILROAD TRACKS
- XXXXX CITY OR VILLAGE LIMITS

TOTAL FEET 27,857 = 5.28 MILES

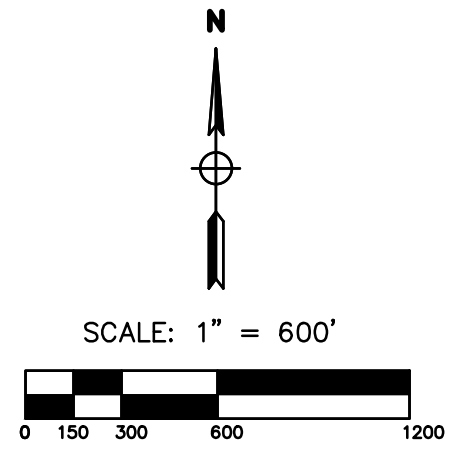

REVISED BY: CLW  
 DATE: 02/20/15

**BANGOR TOWNSHIP**  
 SECTION 18  
 T.14 N. - R.05 E.  
 BAY COUNTY

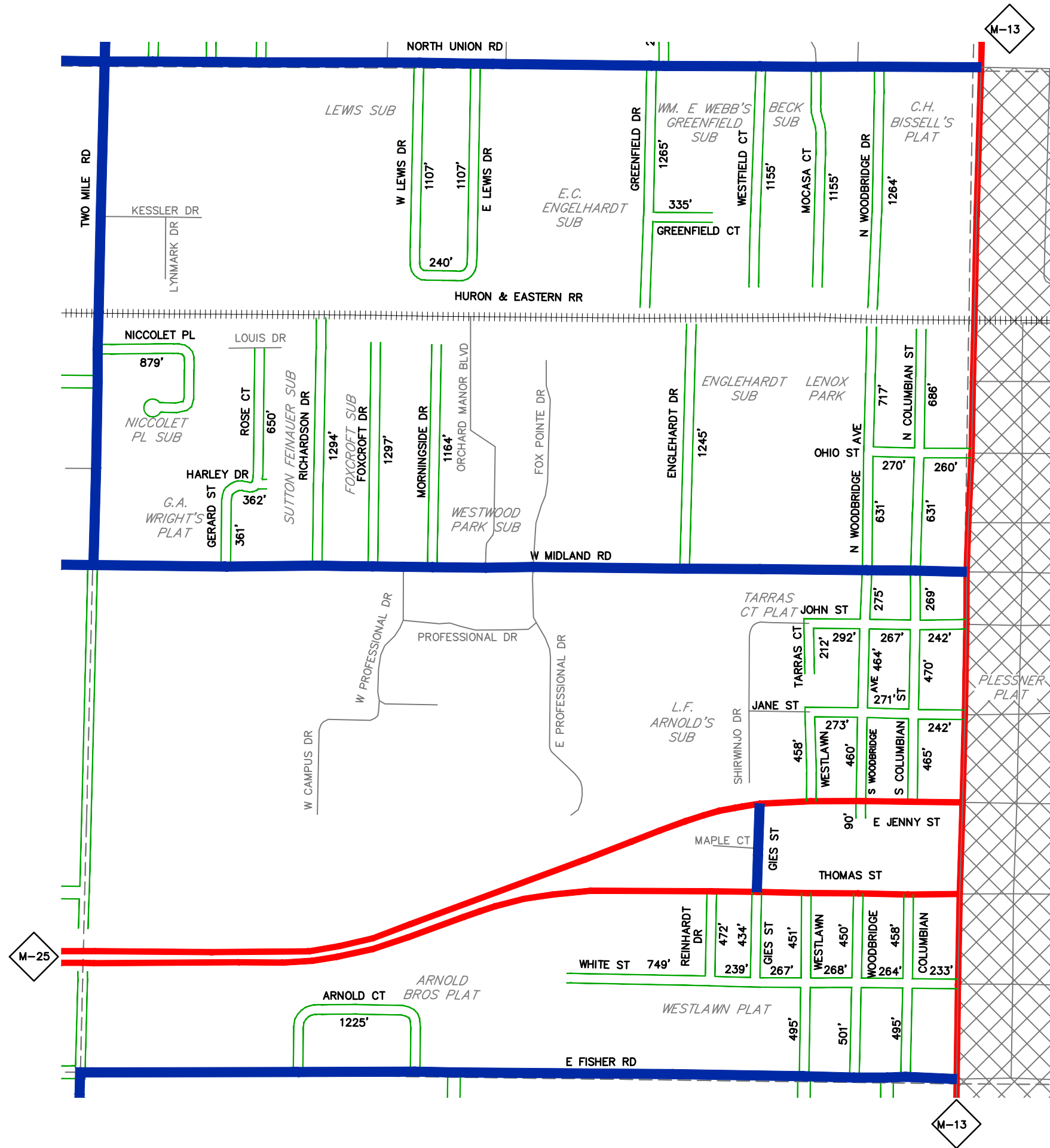

**LEGEND**

- SECTION LINES
- ADJACENT COUNTY
- CITY, VILLAGE OR PRIVATE STREET
- URBAN LIMITS
- COUNTY PRIMARY ROADS
- COUNTY LOCAL ROADS
- STATE TRUNK LINE
- RAILROAD TRACKS
- CITY OR VILLAGE LIMITS

TOTAL FEET **29,826** = **5.65** MILES

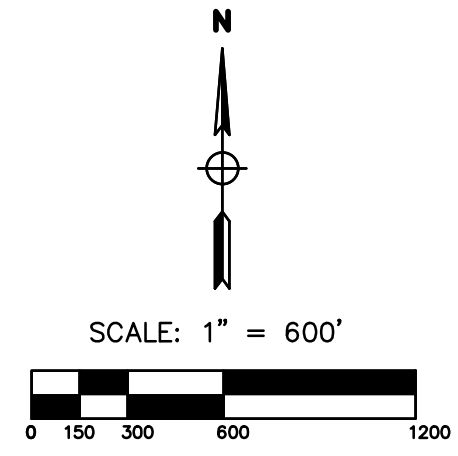

REVISED BY: CLW  
 DATE: 05/05/14

**BANGOR TOWNSHIP**  
 SECTION 19  
 T.14 N. - R.05 E.  
 BAY COUNTY

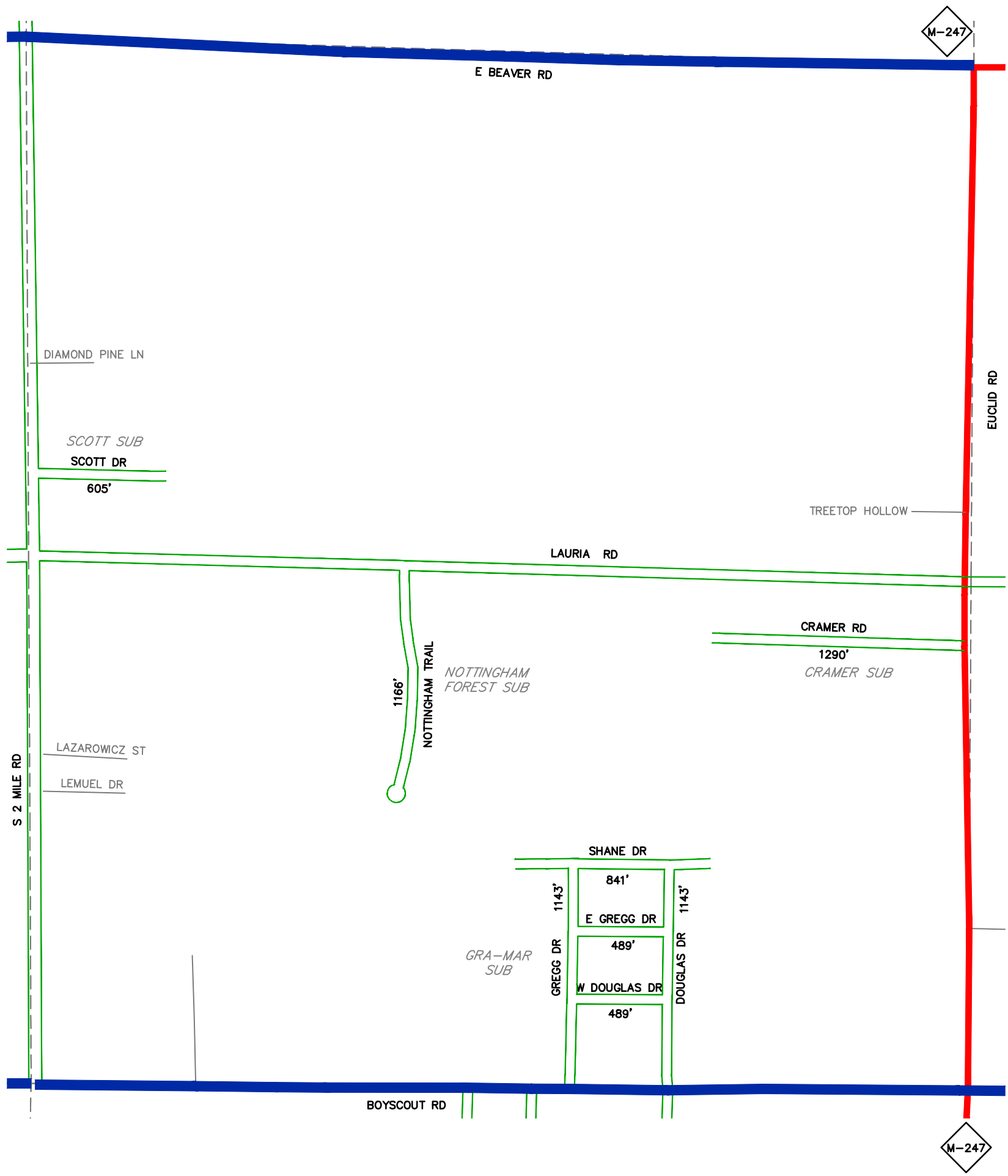

**LEGEND**

- SECTION LINES
- ADJACENT COUNTY
- CITY, VILLAGE OR PRIVATE STREET
- URBAN LIMITS
- COUNTY PRIMARY ROADS
- COUNTY LOCAL ROADS
- STATE TRUNK LINE
- RAILROAD TRACKS
- CITY OR VILLAGE LIMITS

TOTAL FEET 7,166 = 1.36 MILES

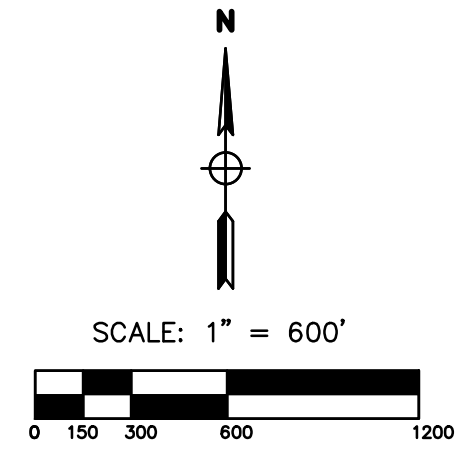

REVISED BY: CLW  
 DATE: 05/05/14

**BANGOR TOWNSHIP**  
 SECTION 31  
 T.15 N. - R.05 E.  
 BAY COUNTY

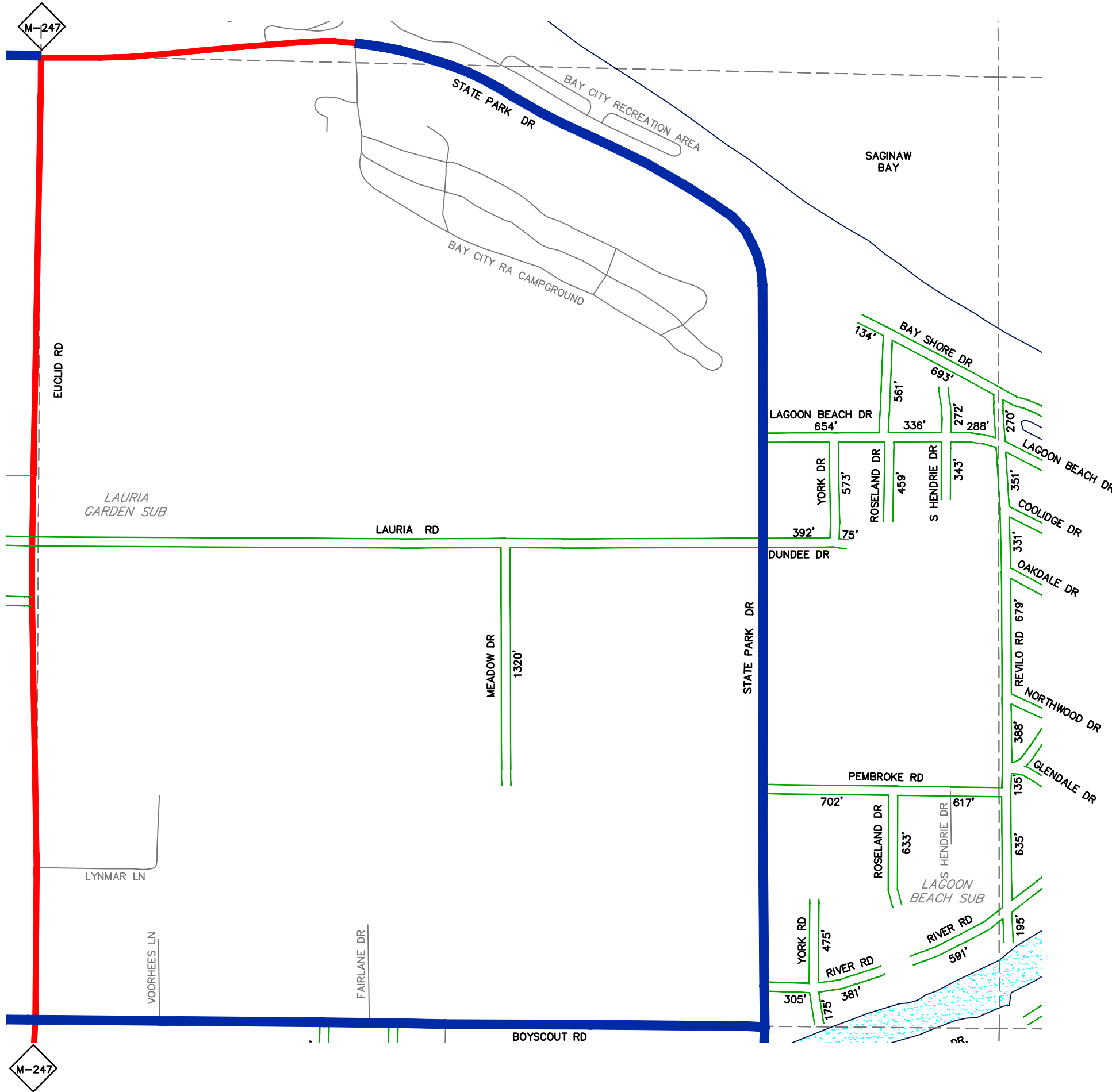

**LEGEND**

- SECTION LINES
- ADJACENT COUNTY
- CITY, VILLAGE OR PRIVATE STREET
- URBAN LIMITS
- COUNTY PRIMARY ROADS
- COUNTY LOCAL ROADS
- STATE TRUNK LINE
- RAILROAD TRACKS
- CITY OR VILLAGE LIMITS

TOTAL FEET 11,643 = 2.21 MILES



SCALE: 1" = 600'

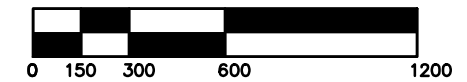

REVISED BY: EJD

DATE: 02/08/19

**BANGOR TOWNSHIP**  
 SECTION 32  
 T.15 N. - R.05 E.  
 BAY COUNTY

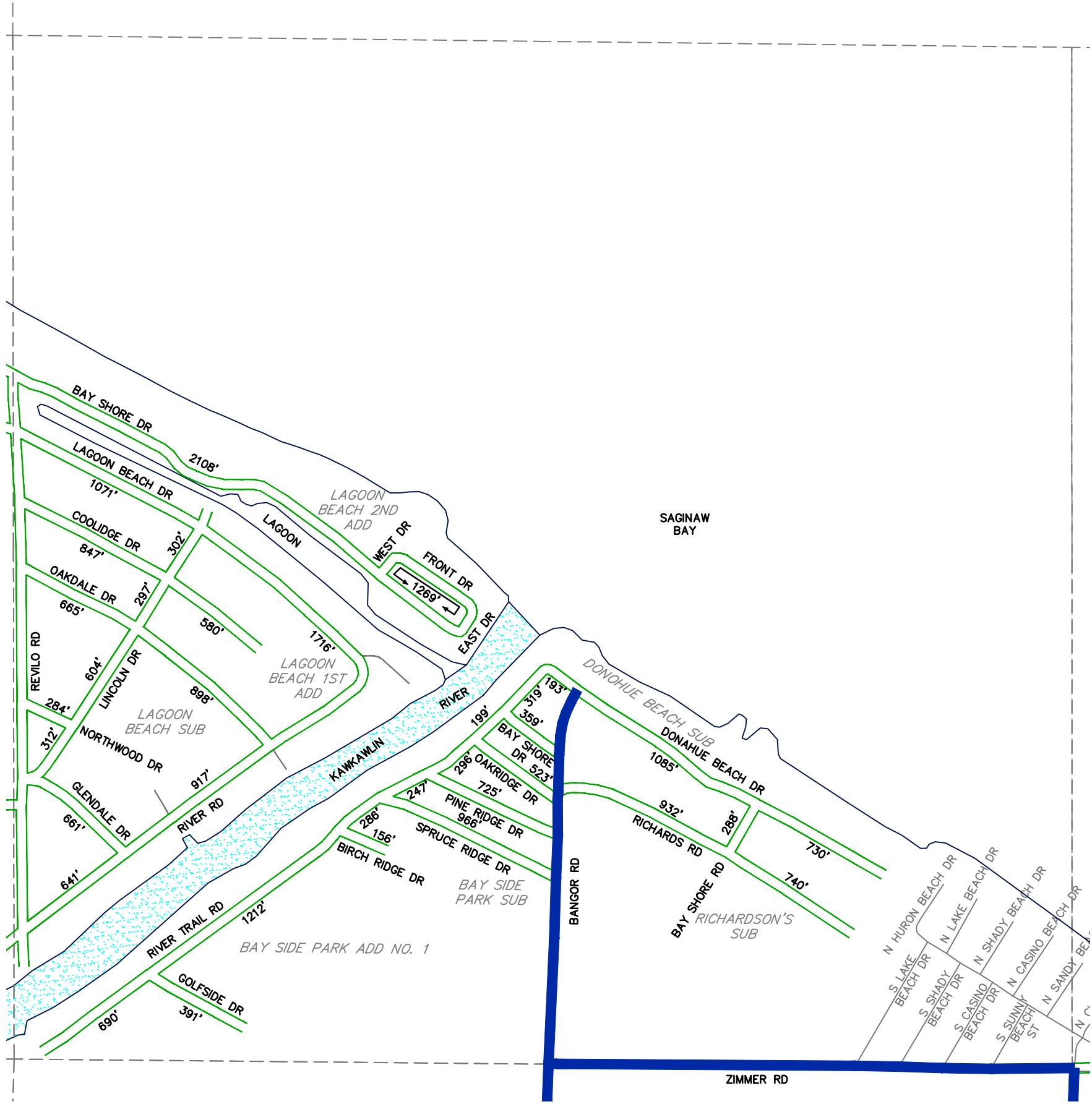

**LEGEND**

- SECTION LINES
- ADJACENT COUNTY
- CITY, VILLAGE OR PRIVATE STREET
- URBAN LIMITS
- COUNTY PRIMARY ROADS
- COUNTY LOCAL ROADS
- STATE TRUNK LINE
- RAILROAD TRACKS
- CITY OR VILLAGE LIMITS

TOTAL FEET 23,171 = 4.39 MILES

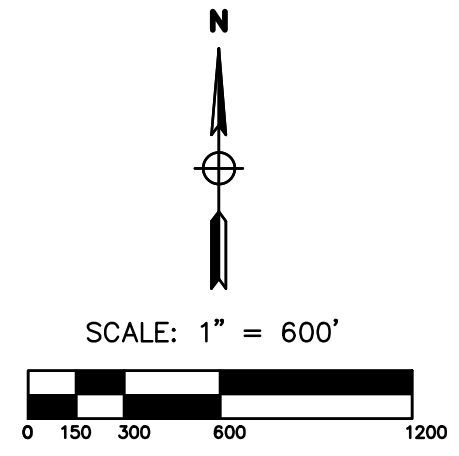

REVISED BY: EJD  
 DATE: 02/08/19

**BANGOR TOWNSHIP**  
 SECTION 33  
 T.15 N. - R.05 E.  
 BAY COUNTY