

**LOCATION MAP**

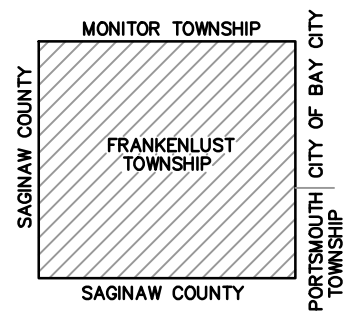

**LEGEND**

- ADJACENT COUNTY
- CITY, VILLAGE OR PRIVATE STREET
- URBAN LIMITS
- COUNTY PRIMARY ROADS
- COUNTY LOCAL ROADS
- STATE TRUNK LINE
- RAILROADS
- CITY OR VILLAGE LIMITS
- SECTION LINES

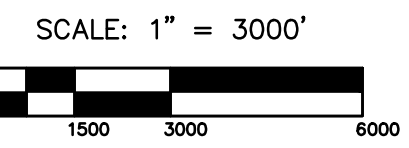

REVISED BY: EJD  
 DATE: 02/08/19

PRIMARY ROAD SYSTEM 16.50 MILES  
 LOCAL ROAD SYSTEM 25.19 MILES

**FRANKENLUST TOWNSHIP**  
 T.13 N. - R.04 & 05 E.  
 BAY COUNTY

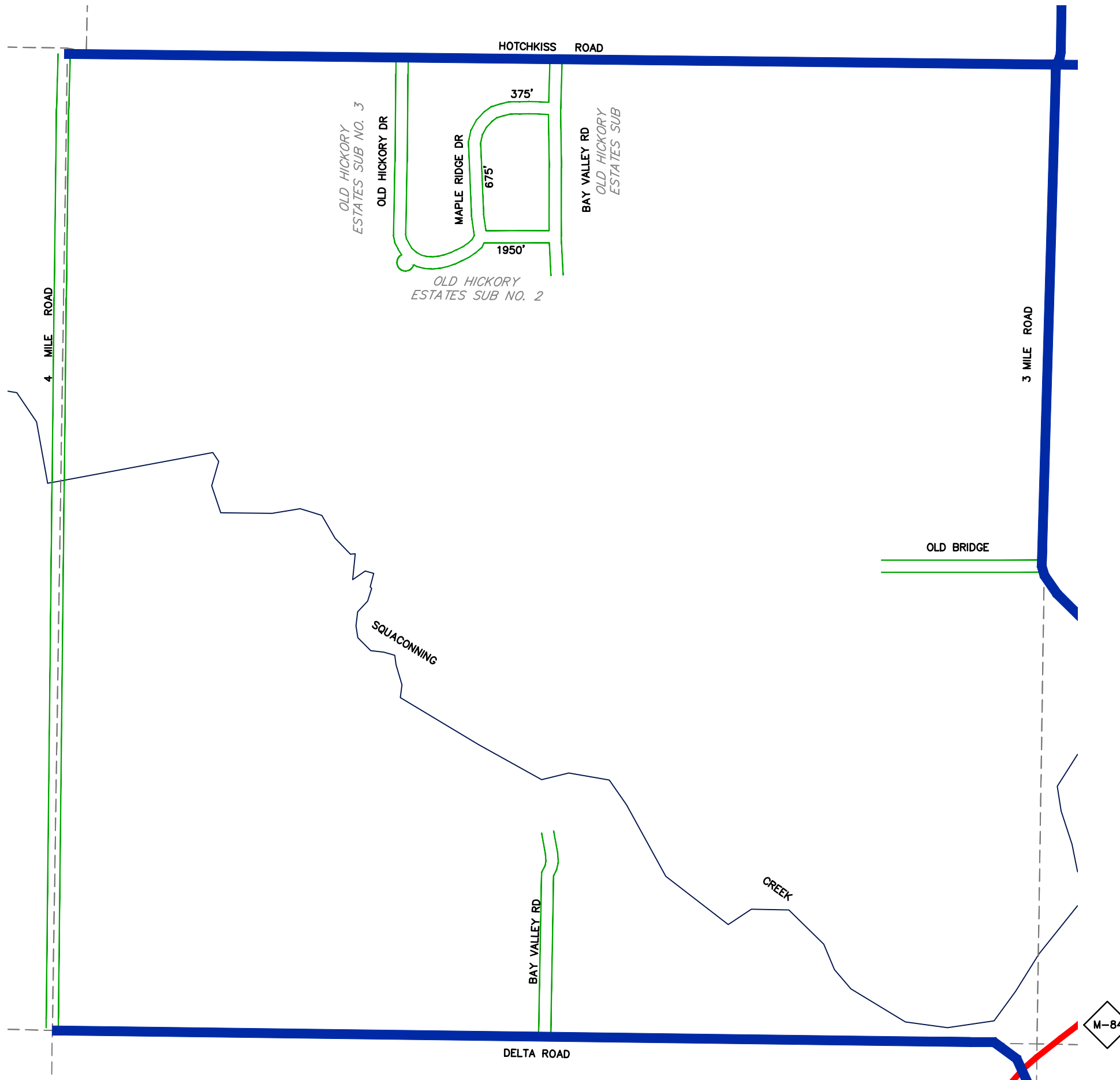

**LEGEND**

- SECTION LINES
- ADJACENT COUNTY
- CITY, VILLAGE OR PRIVATE STREET
- URBAN LIMITS
- COUNTY PRIMARY ROADS
- COUNTY LOCAL ROADS
- STATE TRUNK LINE
- RAILROAD TRACKS
- CITY OR VILLAGE LIMITS

TOTAL FEET 3,000 = 0.57 MILES



SCALE: 1" = 600'

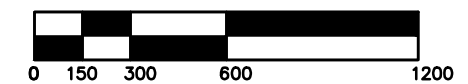

REVISED BY: CLW

DATE: 05/05/14

**FRANKENLUST TOWNSHIP**

SECTION 2  
T.13 N. - R.04 E.  
BAY COUNTY

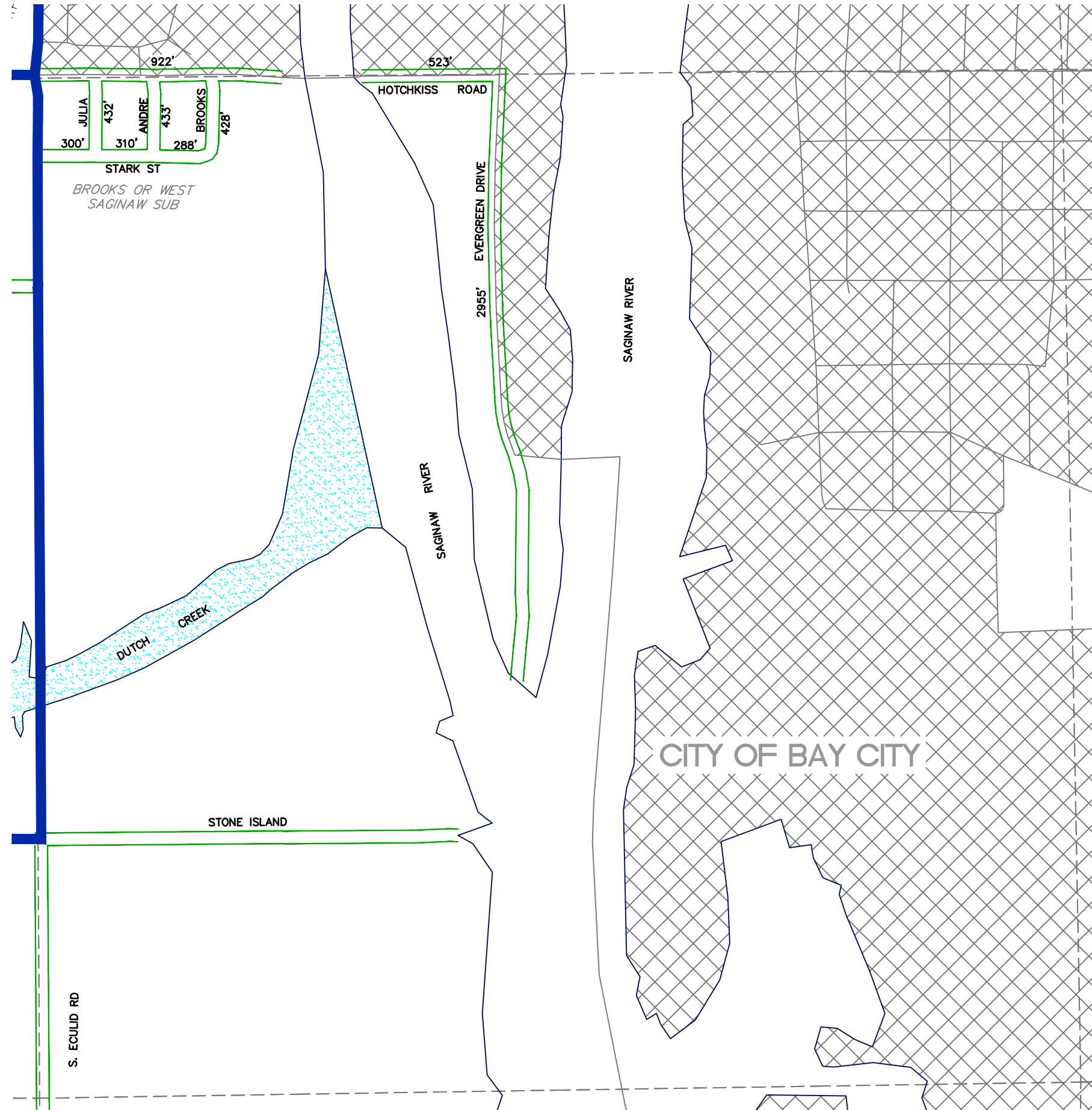

**LEGEND**

- SECTION LINES
- ADJACENT COUNTY
- CITY, VILLAGE OR PRIVATE STREET
- URBAN LIMITS
- COUNTY PRIMARY ROADS
- COUNTY LOCAL ROADS
- STATE TRUNK LINE
- RAILROAD TRACKS
- CITY OR VILLAGE LIMITS

TOTAL FEET 6,591 = 1.25 MILES

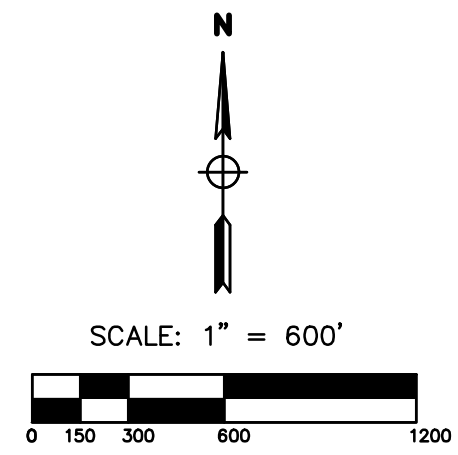

REVISED BY: CLW  
 DATE: 05/05/14

FRANKENLUST TOWNSHIP  
 SECTION 5  
 T.13 N. - R.05 E.  
 BAY COUNTY

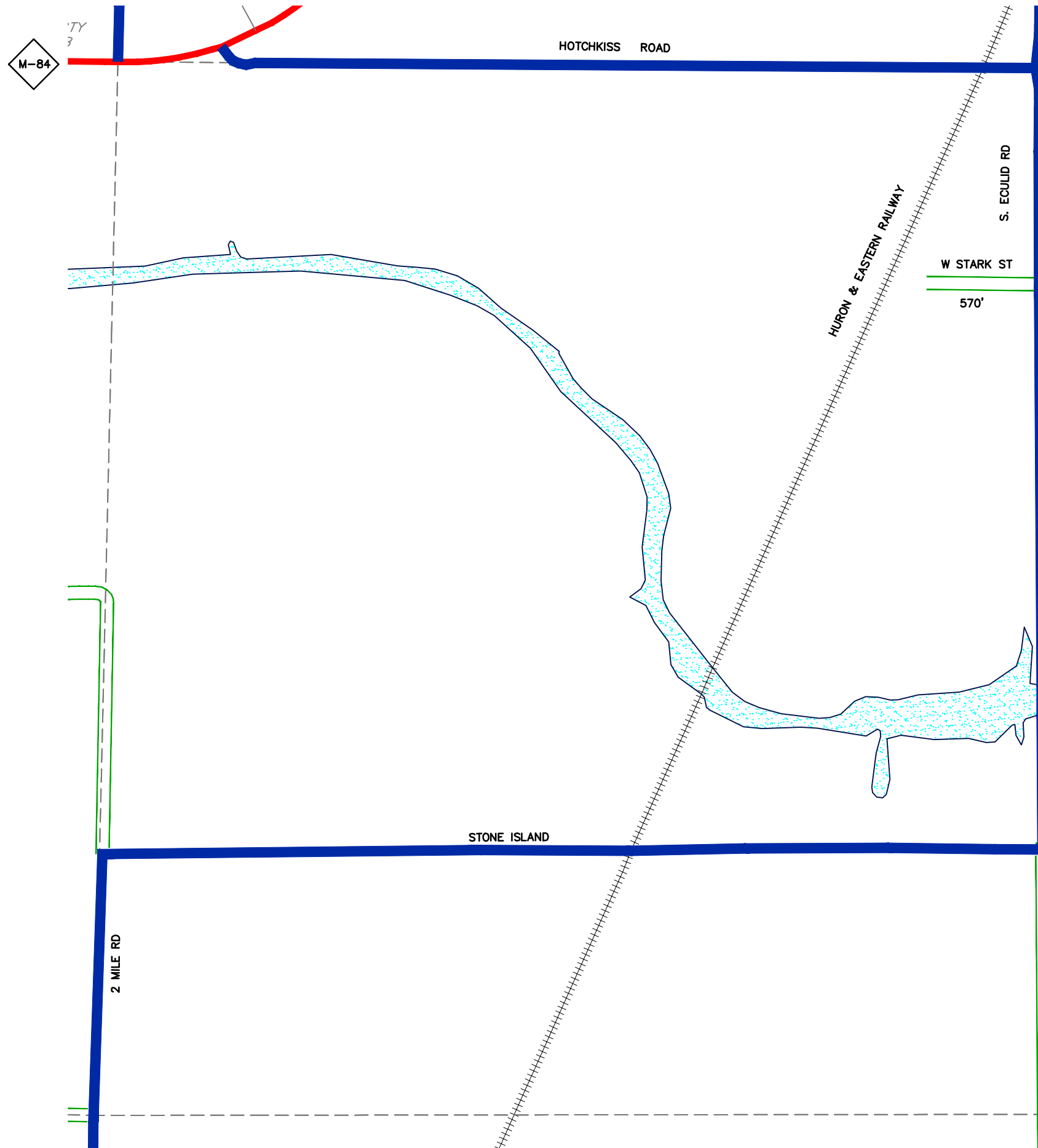

**LEGEND**

- SECTION LINES
- ADJACENT COUNTY
- CITY, VILLAGE OR PRIVATE STREET
- URBAN LIMITS
- COUNTY PRIMARY ROADS
- COUNTY LOCAL ROADS
- STATE TRUNK LINE
- RAILROAD TRACKS
- CITY OR VILLAGE LIMITS

TOTAL FEET 570 = 0.11 MILES

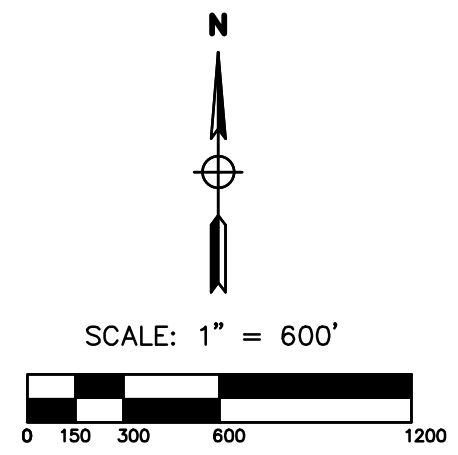

REVISED BY: EJD  
 DATE: 02/08/19

FRANKENLUST TOWNSHIP  
 SECTION 6  
 T.13 N. - R.05 E.  
 BAY COUNTY

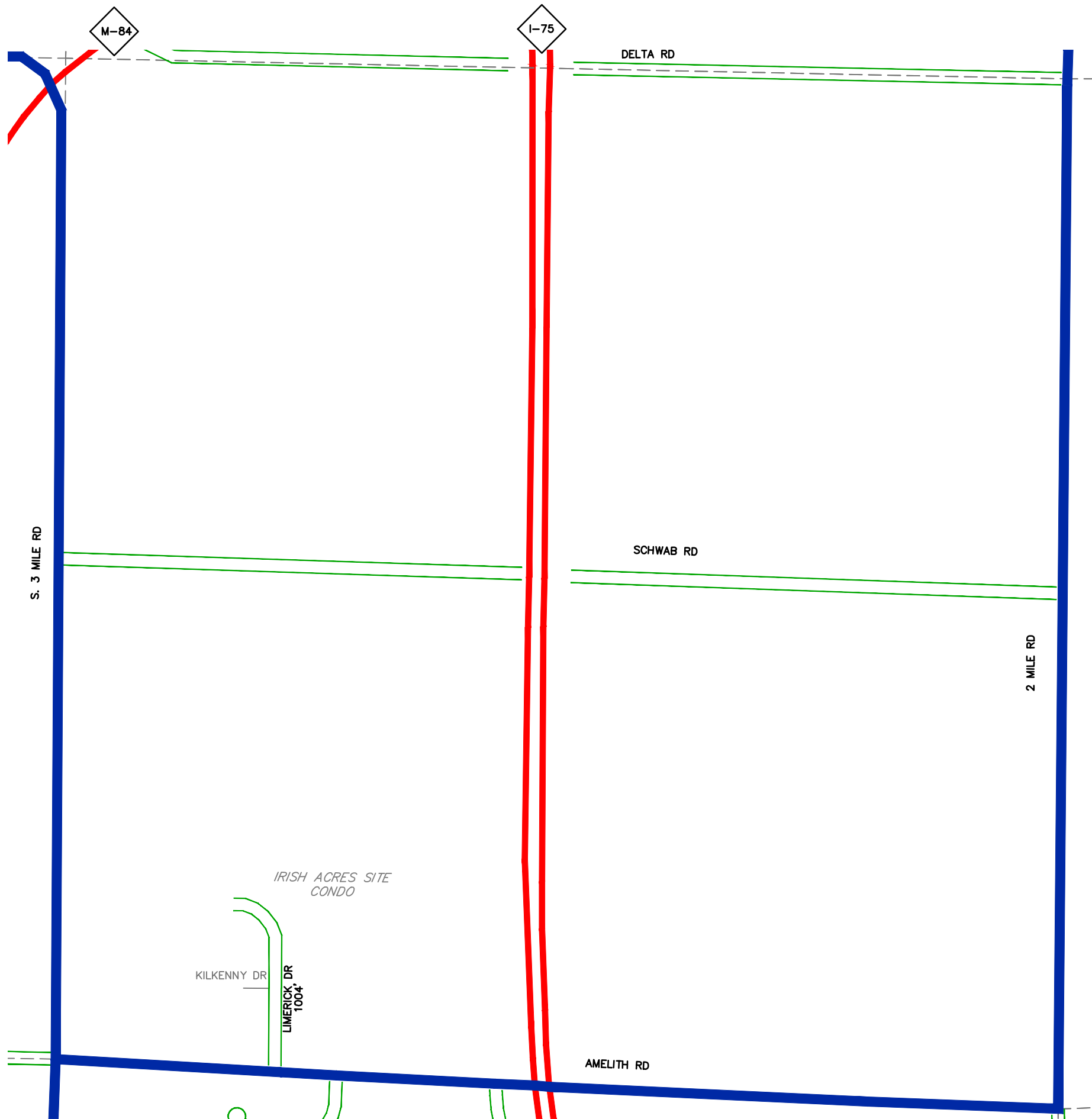

**LEGEND**

- SECTION LINES
- ADJACENT COUNTY
- CITY, VILLAGE OR PRIVATE STREET
- URBAN LIMITS
- COUNTY PRIMARY ROADS
- COUNTY LOCAL ROADS
- STATE TRUNK LINE
- RAILROAD TRACKS
- CITY OR VILLAGE LIMITS

TOTAL FEET 1,004 = 0.19 MILES



SCALE: 1" = 600'

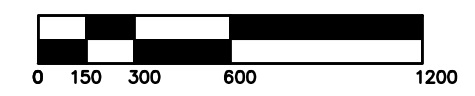

REVISED BY: EJD

DATE: 02/08/19

FRANKENLUST TOWNSHIP  
 SECTION 12  
 T.13 N. - R.04 E.  
 BAY COUNTY

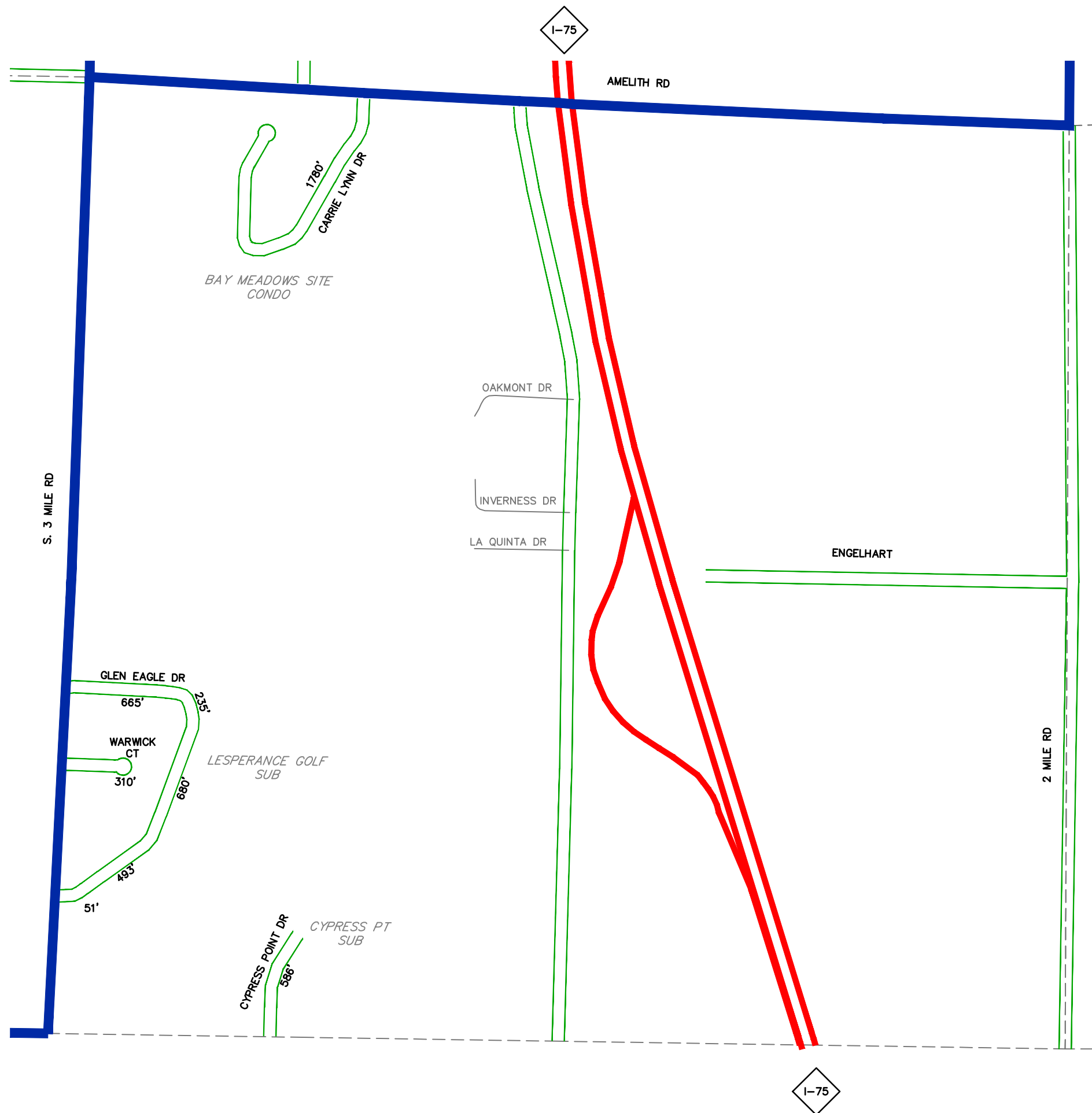

**LEGEND**

- SECTION LINES
- ADJACENT COUNTY
- CITY, VILLAGE OR PRIVATE STREET
- URBAN LIMITS
- COUNTY PRIMARY ROADS
- COUNTY LOCAL ROADS
- STATE TRUNK LINE
- RAILROAD TRACKS
- CITY OR VILLAGE LIMITS

TOTAL FEET 4,800 = 0.91 MILES

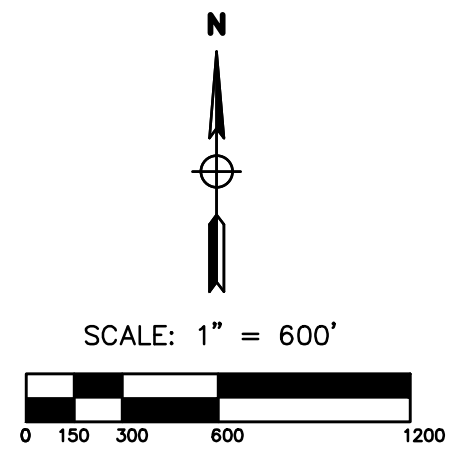

REVISED BY: CLW  
 DATE: 05/05/14

FRANKENLUST TOWNSHIP  
 SECTION 13  
 T.13 N. - R.04 E.  
 BAY COUNTY

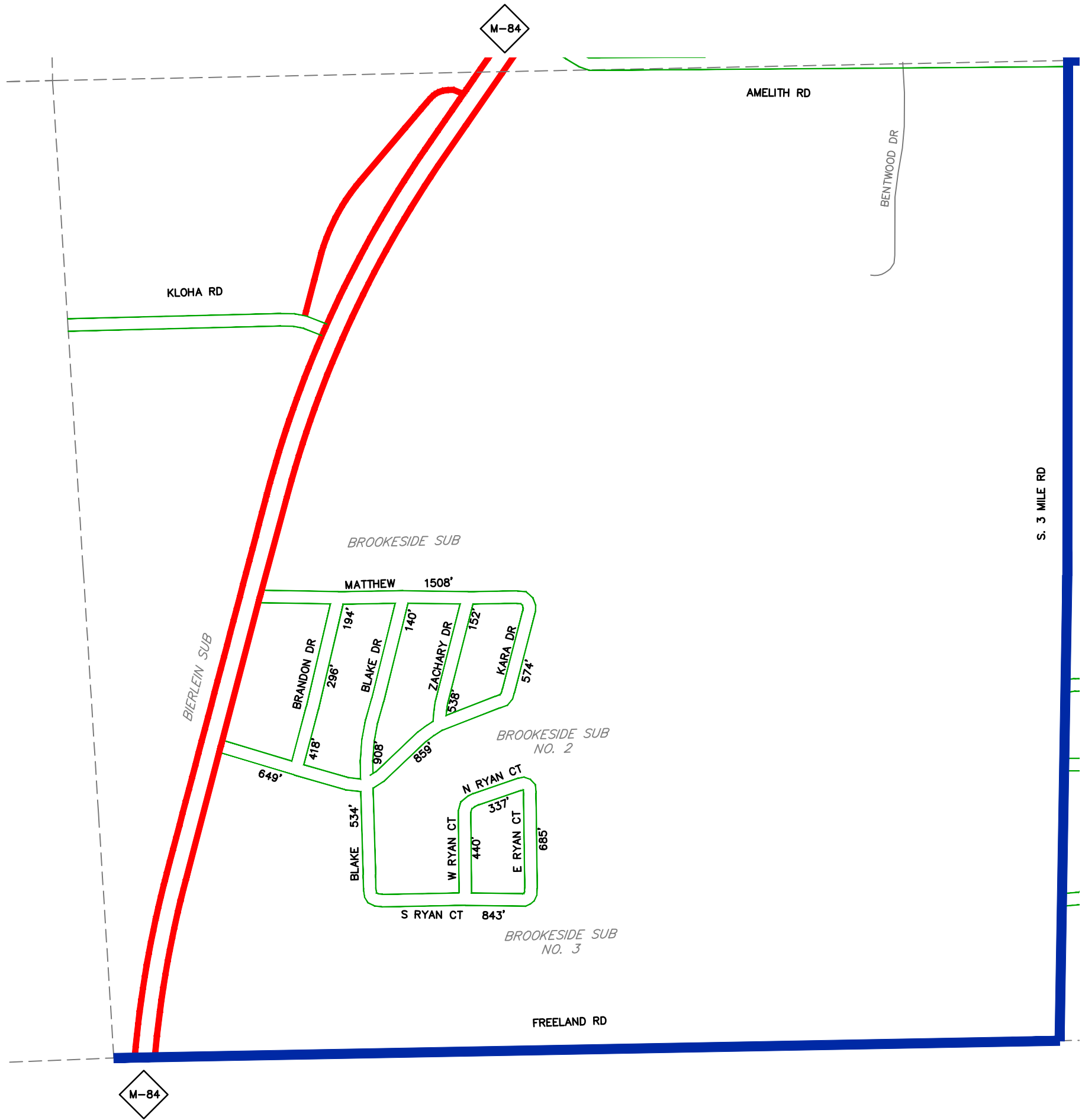

**LEGEND**

- SECTION LINES
- ADJACENT COUNTY
- CITY, VILLAGE OR PRIVATE STREET
- URBAN LIMITS
- COUNTY PRIMARY ROADS
- COUNTY LOCAL ROADS
- STATE TRUNK LINE
- RAILROAD TRACKS
- CITY OR VILLAGE LIMITS

TOTAL FEET 9,075 = 1.72 MILES

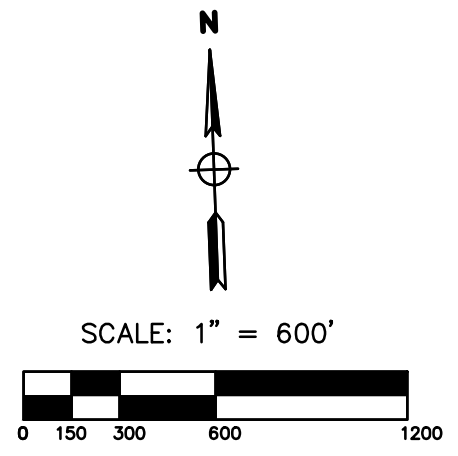

REVISED BY: CLW  
 DATE: 05/05/14

FRANKENLUST TOWNSHIP  
 SECTION 14  
 T.13 N. - R.04 E.  
 BAY COUNTY