

SCALE: 1" = 3000'

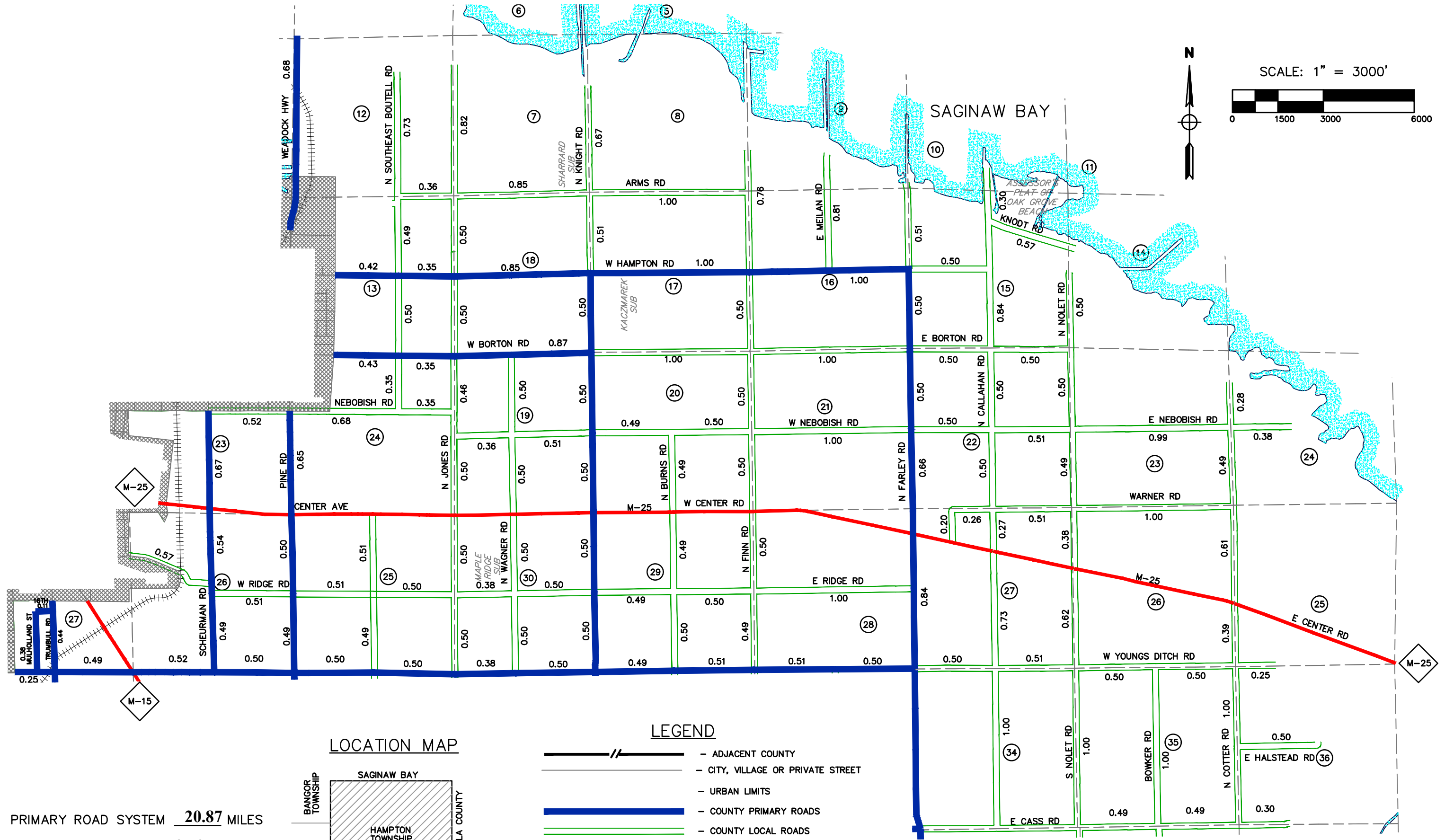

LOCATION MAP

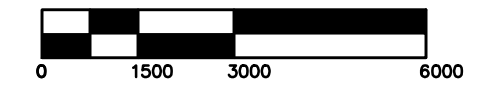
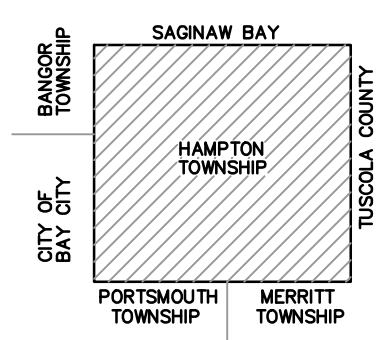

PRIMARY ROAD SYSTEM 20.87 MILES

LOCAL ROAD SYSTEM 52.50 MILES

LEGEND

- ADJACENT COUNTY
- CITY, VILLAGE OR PRIVATE STREET
- URBAN LIMITS
- COUNTY PRIMARY ROADS
- COUNTY LOCAL ROADS
- STATE TRUNK LINE
- RAILROADS
- CITY OR VILLAGE LIMITS
- SECTION LINES

HAMPTON TOWNSHIP

REVISED BY: CLW

T.14 N. - R.05&06 E.
BAY COUNTY

DATE: 05/05/14

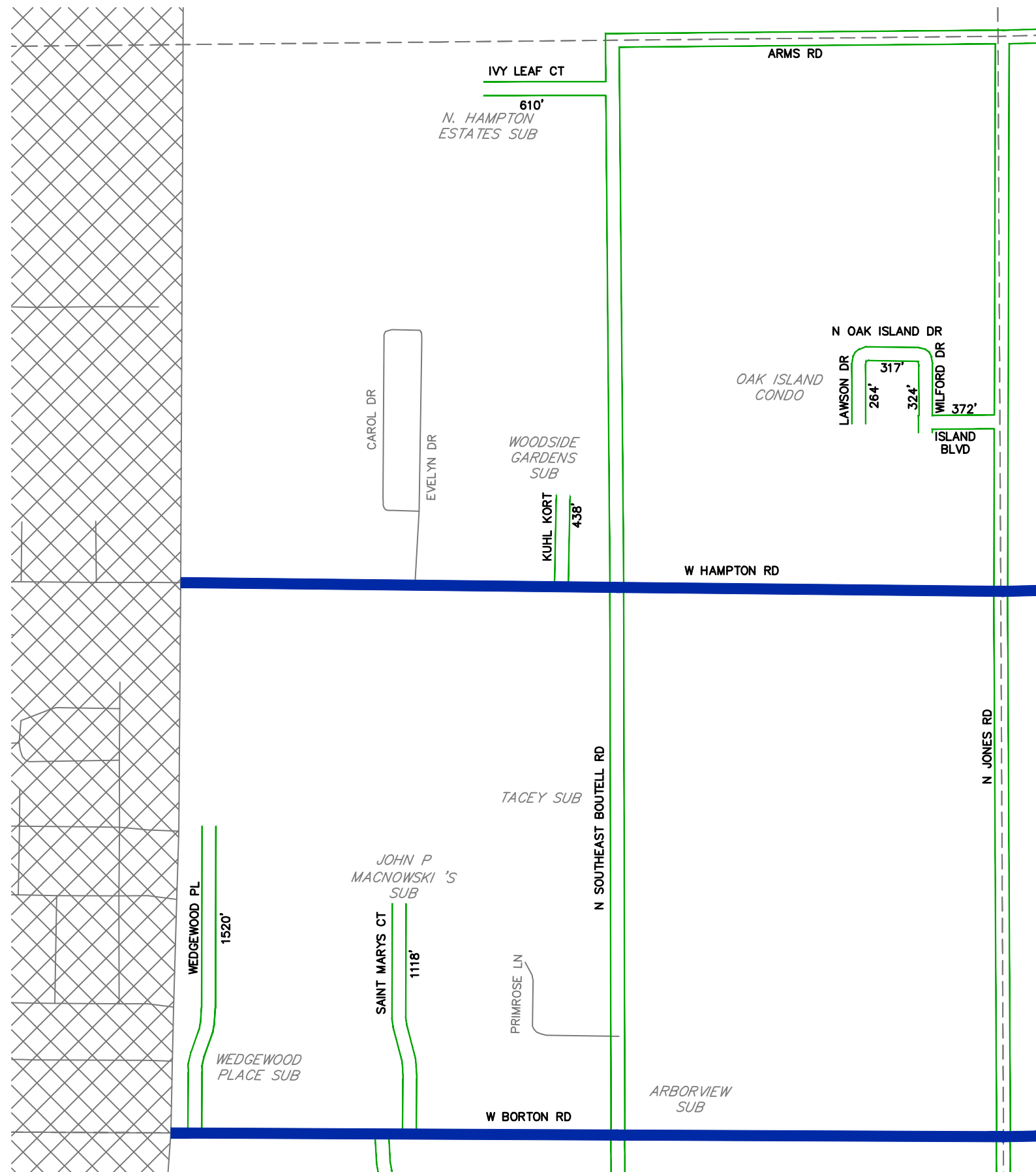

LEGEND

- SECTION LINES
- ADJACENT COUNTY
- CITY, VILLAGE OR PRIVATE STREET
- URBAN LIMITS
- COUNTY PRIMARY ROADS
- COUNTY LOCAL ROADS
- STATE TRUNK LINE
- RAILROAD TRACKS
- CITY OR VILLAGE LIMITS

TOTAL FEET 4,963 = 0.94 MILES

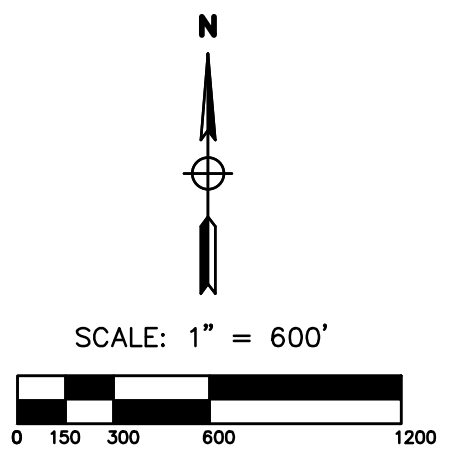

REVISED BY: CLW
 DATE: 05/05/14

HAMPTON TOWNSHIP
 SECTION 13
 T.14 N. - R.05 E.
 BAY COUNTY

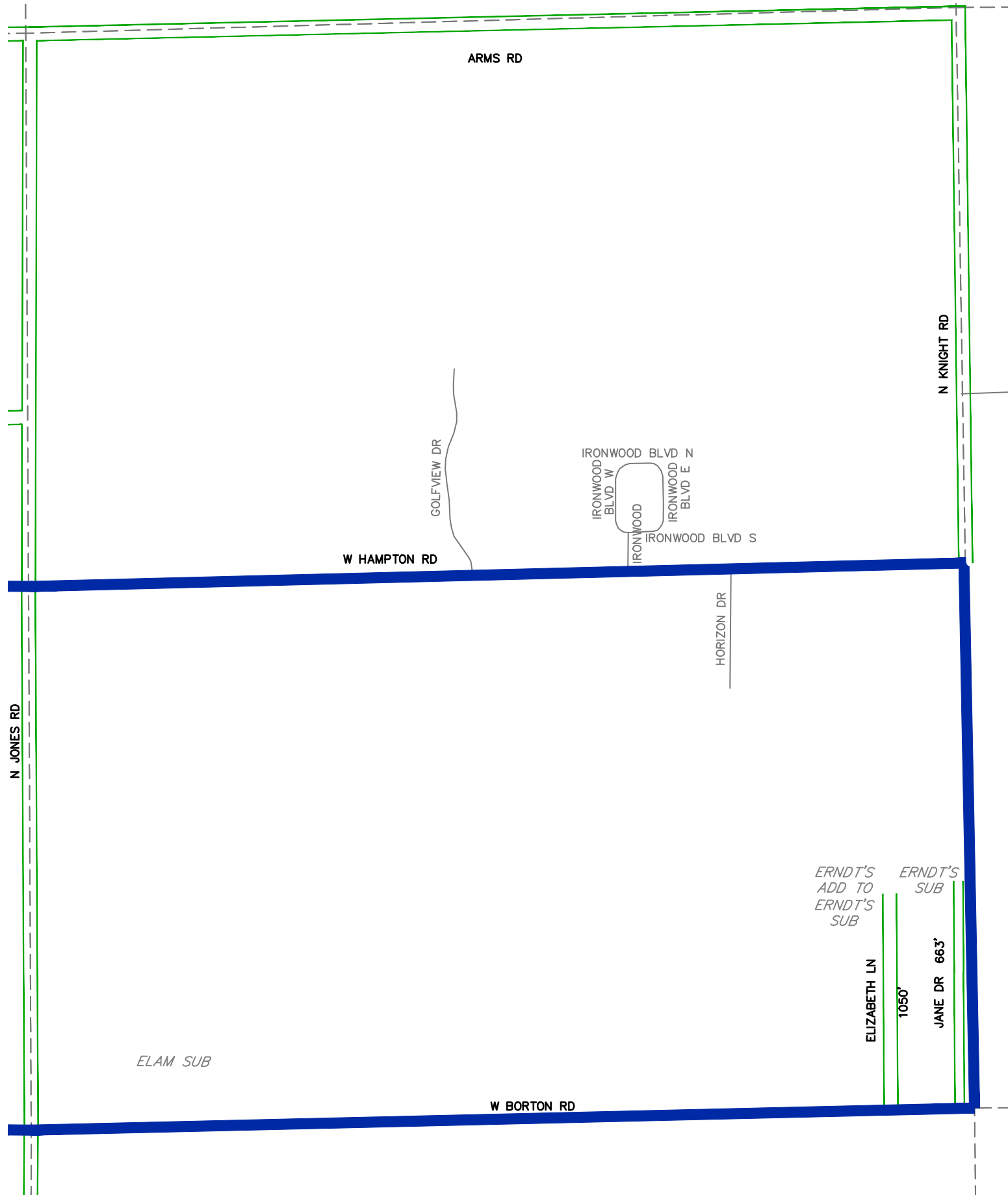

LEGEND

- SECTION LINES
- ADJACENT COUNTY
- CITY, VILLAGE OR PRIVATE STREET
- URBAN LIMITS
- COUNTY PRIMARY ROADS
- COUNTY LOCAL ROADS
- STATE TRUNK LINE
- RAILROAD TRACKS
- CITY OR VILLAGE LIMITS

TOTAL FEET 1,713 = 0.32 MILES



SCALE: 1" = 600'

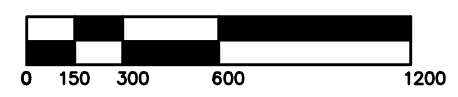

REVISED BY: CLW

DATE: 05/05/14

HAMPTON TOWNSHIP
SECTION 18
T.14 N. - R.06 E.
BAY COUNTY

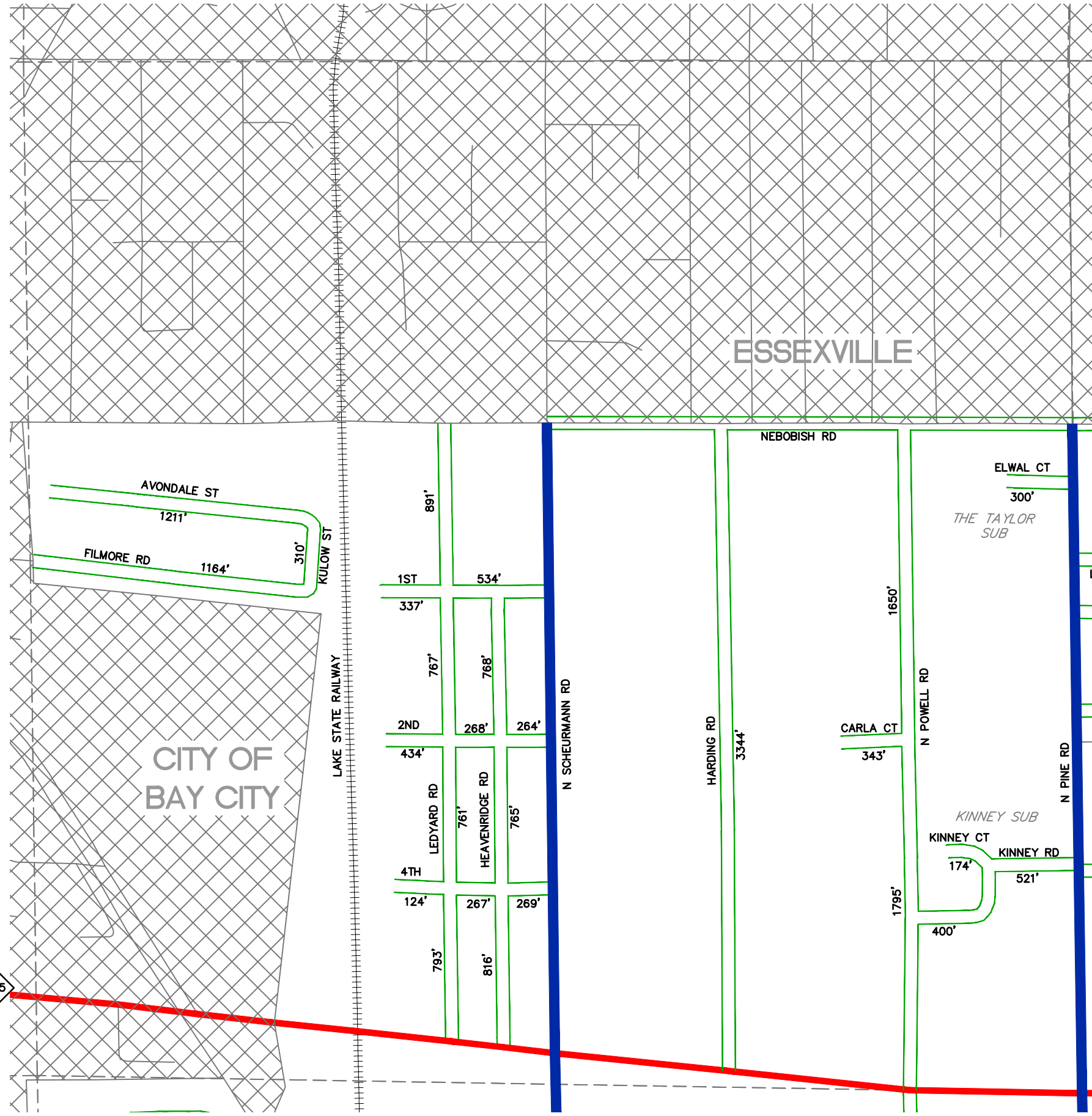

LEGEND

- SECTION LINES
- ADJACENT COUNTY
- CITY, VILLAGE OR PRIVATE STREET
- URBAN LIMITS
- COUNTY PRIMARY ROADS
- COUNTY LOCAL ROADS
- STATE TRUNK LINE
- RAILROAD TRACKS
- CITY OR VILLAGE LIMITS

TOTAL FEET 19,535 = 3.70 MILES



SCALE: 1" = 600'

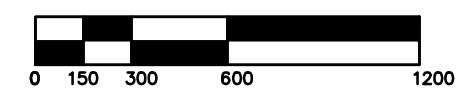

REVISED BY: CLW

DATE: 05/05/14

HAMPTON TOWNSHIP
SECTION 23
T.14 N. - R.05 E.
BAY COUNTY

M-25

M-25

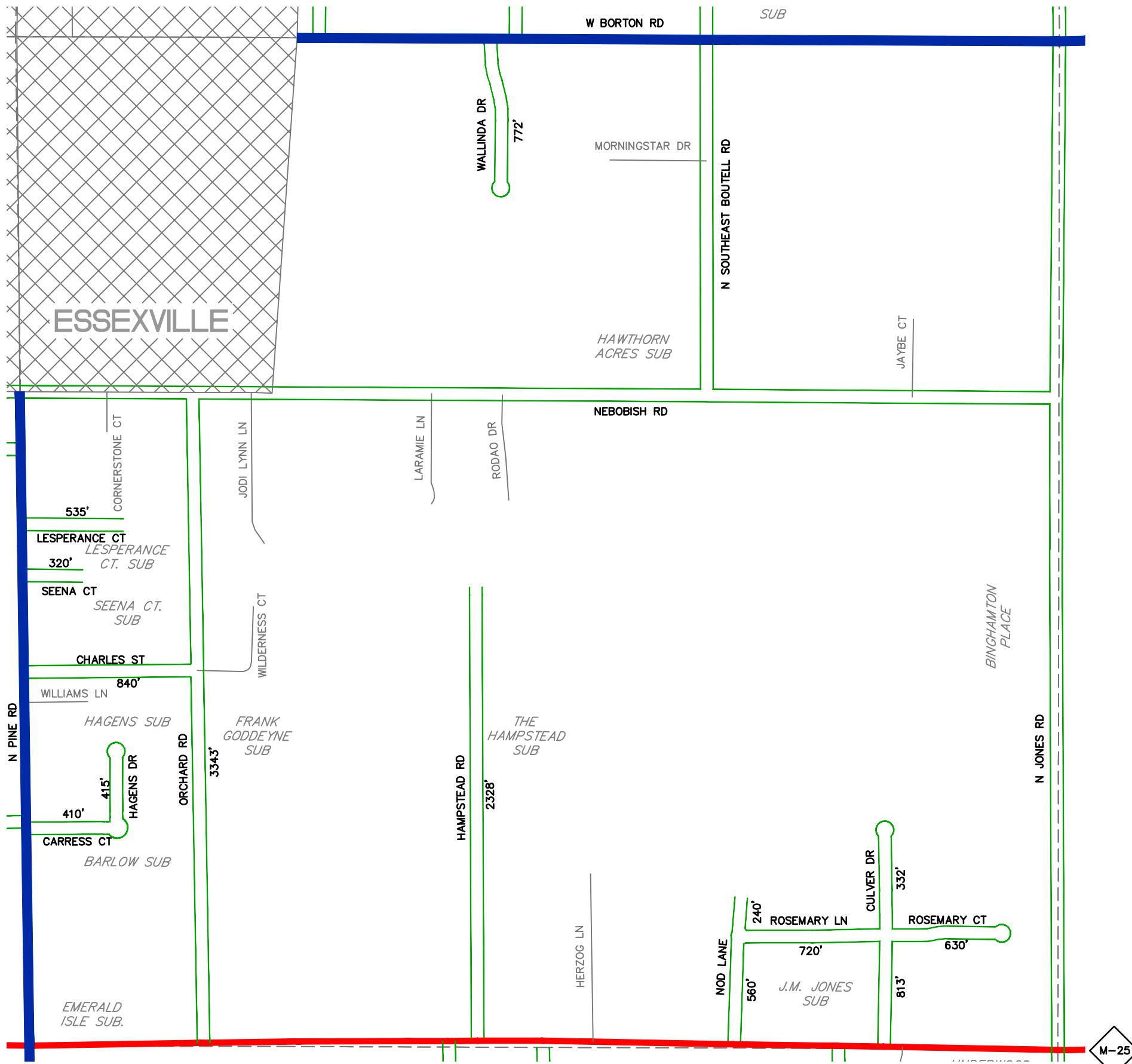

LEGEND

- SECTION LINES
- ADJACENT COUNTY
- CITY, VILLAGE OR PRIVATE STREET
- URBAN LIMITS
- COUNTY PRIMARY ROADS
- COUNTY LOCAL ROADS
- STATE TRUNK LINE
- RAILROAD TRACKS
- CITY OR VILLAGE LIMITS

TOTAL FEET 12,238 = 2.32 MILES

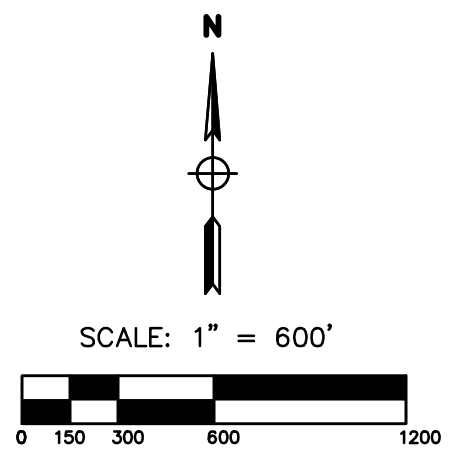

REVISED BY: CLW
 DATE: 05/05/14

HAMPTON TOWNSHIP
 SECTION 24
 T.14 N. - R.05 E.
 BAY COUNTY

M-25

M-25

7-24

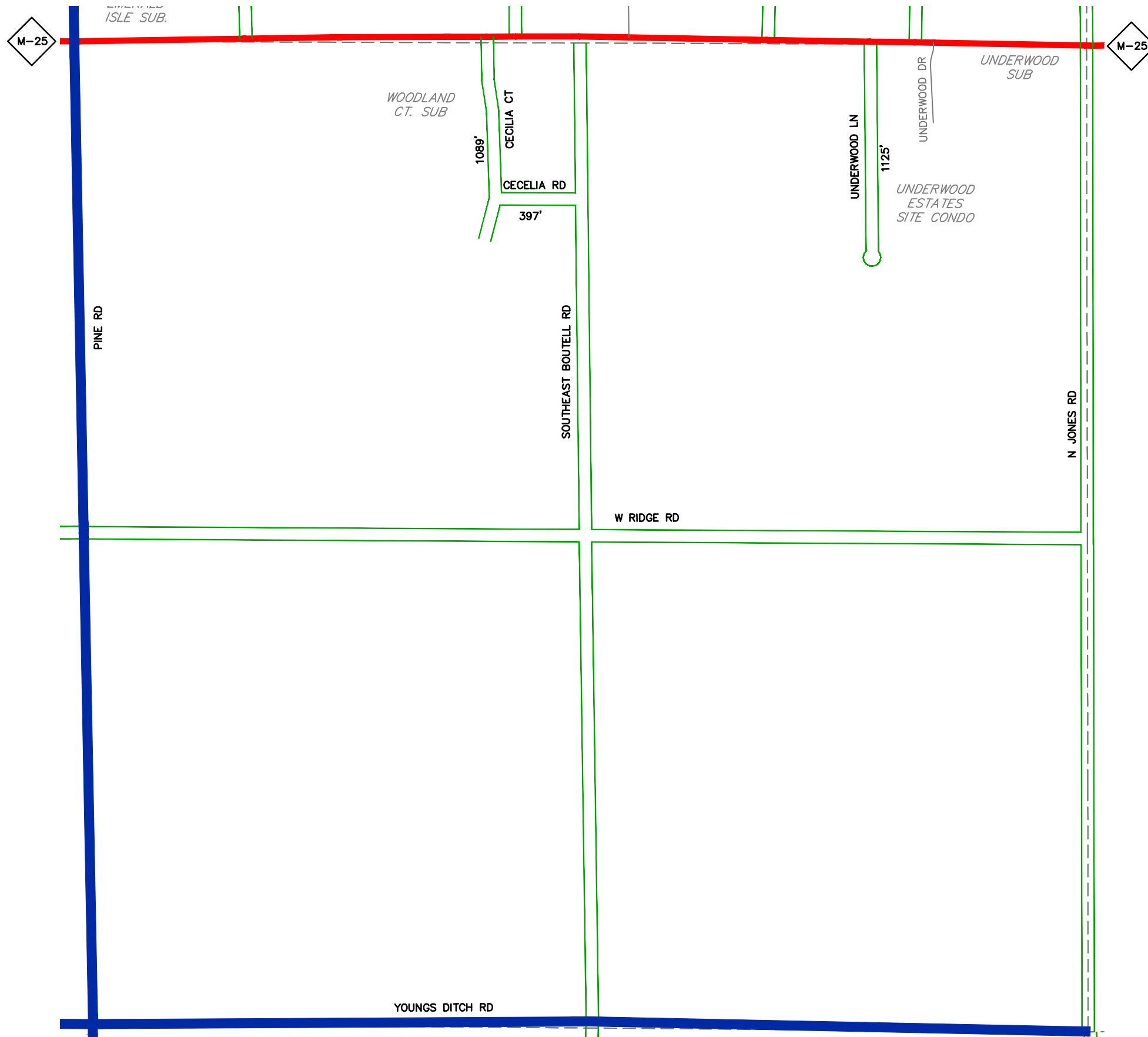

LEGEND

- SECTION LINES
- ADJACENT COUNTY
- CITY, VILLAGE OR PRIVATE STREET
- URBAN LIMITS
- COUNTY PRIMARY ROADS
- COUNTY LOCAL ROADS
- STATE TRUNK LINE
- RAILROAD TRACKS
- CITY OR VILLAGE LIMITS

TOTAL FEET 2,611 = 0.49 MILES

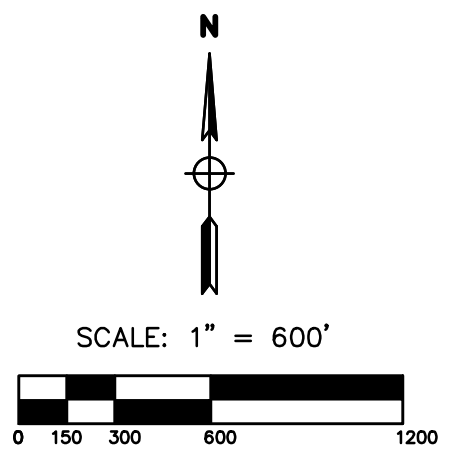

REVISED BY: CLW
 DATE: 05/05/14

HAMPTON TOWNSHIP
 SECTION 25
 T.14 N. - R.05 E.
 BAY COUNTY

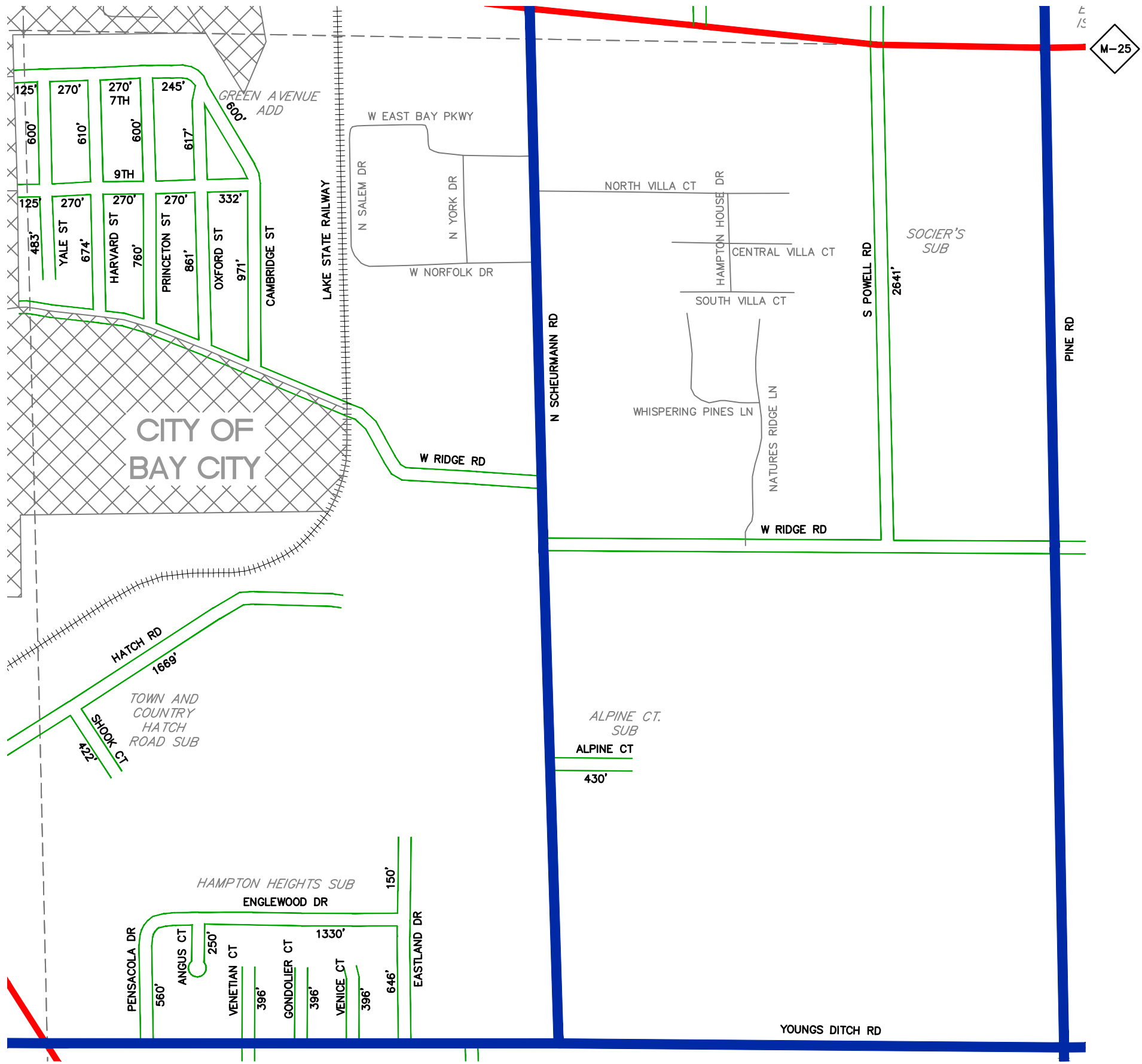

LEGEND

- SECTION LINES
- ADJACENT COUNTY
- CITY, VILLAGE OR PRIVATE STREET
- URBAN LIMITS
- COUNTY PRIMARY ROADS
- COUNTY LOCAL ROADS
- STATE TRUNK LINE
- RAILROAD TRACKS
- CITY OR VILLAGE LIMITS

TOTAL FEET 18,239 = 3.45 MILES



SCALE: 1" = 600'

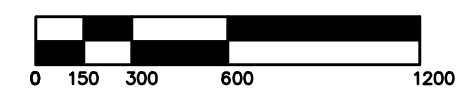

REVISED BY: CLW

DATE: 05/05/14

HAMPTON TOWNSHIP

SECTION 26
T.14 N. - R.05 E.
BAY COUNTY

CITY OF
BAY CITY

15TH ST

737'

16TH ST

JOHNSON ST

MULHOLLAND ST

TRUMBULL RD

TUREK SUB

21ST ST

530'

YOUNGS DITCH RD

ROSELL CT

220'

SPENGLER DR

627'

FAIROAKS DR

410'

DONETHA SUB

SIMON ST

PARK 128

CEDAR DR

860'

PINEWOOD CT

823'

FREDRICK ST

THE DEZELSKY SUB

AVALON CIR

888'

SPECKHARD'S SUB

LAKE STATE RAILWAY

HATCH RD

975'

M-15

JAMES WATSON'S

LEGEND

- SECTION LINES
- ADJACENT COUNTY
- CITY, VILLAGE OR PRIVATE STREET
- URBAN LIMITS
- COUNTY PRIMARY ROADS
- COUNTY LOCAL ROADS
- STATE TRUNK LINE
- RAILROAD TRACKS
- CITY OR VILLAGE LIMITS

TOTAL FEET 6,704 = 1.27 MILES



SCALE: 1" = 600'

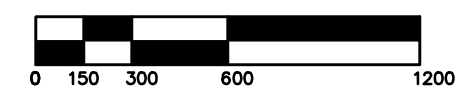

REVISED BY: CLW

DATE: 05/05/14

HAMPTON TOWNSHIP

SECTION 27
T.14 N. - R.05 E.
BAY COUNTY